

## Reservation Information

► Reservations are taken for a minimum 2 night stay, except holidays which require a minimum 3 night stay.

► If your reservation is made 14 days or more prior to your stay, the required payment is due within 10 days of making the reservation.

► If your reservation is made less than 14 days prior to your stay, the required payment is due immediately upon making the reservation.



## Camping Information

► One major camping unit is allowed per site (An additional small tent, no larger than 50 sq. ft. is also permitted).

► A site may be occupied by only 1 family (no more than 6 people), or 1 group (no more than 4 people).

► Campsites may only be registered by a person 18 years or older and who is staying on the site.

► **Check-Out: 1:00 p.m. Check-In: 3:00 p.m.**

► Campsites #1 through #22 at Coldwater Lake Family Park may not be occupied for more than 14 days at a time. At the end of the 14 days, the camping unit must be taken off and moved to another site (other than 1-22) for a minimum of 2 nights or removed from the park.

► **Park Entrance Permit (PEP):** A PEP for your vehicle is included with your reservation. Additional motor vehicles may enter with the purchase of a Daily or Annual Pass. All permits and passes must be properly affixed on the inside of the vehicle (driver's side) windshield.

► **Cabin Key Deposit:** \$10 deposit which is refunded upon return of the cabin key.

## Camping Refund Policy

All refunds are processed at Park Headquarters and are subject to the following conditions:

► If cancellation is received at least 5 days prior to beginning of stay, the refund will be the amount paid less a \$15 cancellation processing charge.

► If cancellation is received less than 5 days prior to beginning of stay, the refund will be the amount paid less \$15 cancellation processing charge and 1 night camping fee.

► Once occupied, a refund for a campsite (that has been reserved in advance) will only be made for 5 or more nights, less any minimum stay requirements. For less than 5 nights, a credit towards future camping will be provided for each night cancelled, less minimum stay requirements.

► Cancellation of all or portion of a campground visit may be made by mail, telephone or in person. Cancellations may not be made by email. Failure to notify of cancellation in a timely manner may result in partial or full forfeiture of camping fees paid.

► Refunds/credits for discounted (monthly) rates for sites occupied and vacated early are calculated in the following manner: A cancellation fee of \$50 is charged for each cancelled 30 consecutive night reservation up to March 31. Cancellations made after this date and at least 30 days from the beginning of your stay will be charged the \$50 fee plus half of the reservation charge. There are no refunds for cancellations after this time.

► If desired, campers may seek additional refund consideration by placing their request in writing. Mail requests to: Isabella County Parks, 200 N. Main Street, Mt. Pleasant, MI 48858 or email to [parks@isabellacounty.org](mailto:parks@isabellacounty.org).

► Isabella County Parks and Recreation Commission reserves the right to interpret and enforce park rules at its discretion. (Reference Park Rules & Ordinance)



## Coldwater Lake Family Park

1703 N. Littlefield Rd, Weidman, MI 48893  
989.644.2388 or 989.772.0911 ext. 340

- Open May through Mid-October
- Reservations Recommended
- 95 Modern Campsites & 5 Rustic Cabins
- Water & 20/30 amp Electric Hook-Up
- Barrier Free RV Dump-station & Bathhouse
- Sandy Swimming Beach & Boat Launch
- Playground, Volleyball, & Horseshoes
- Picnic Area with Pavilion Rentals
- 28-Acre Park on Coldwater Lake (All Sports Lake)

## Herrick Recreation Area

6320 E. Herrick Rd, Clare, MI 48617  
989.386.2010 or 989.772.0911 ext. 340

- Open May through Mid-October
- Reservations Recommended
- 113-Acre Park with Boat Launch
- 73 Modern Campsites and 5 Rustic Cabins
- Central Water Outlets & 20/30 amp Electric Hook-up
- RV Dump-station
- Barrier Free Bathhouse
- Sandy Swimming Beach & 3 Fishing Ponds
- Playground, Volleyball & Horseshoes
- Picnic Area with Pavilion Rentals
- Pere Marquette Rail-Trail Nearby  
(Clare to Midland 30+ Miles)

## Deerfield Nature Park

2425 W. Remus Rd, Mt. Pleasant, MI 48858  
989.772.2879 or 989.772.0911 ext. 340

- Open All Year
- 591-Acre Park Located on the Chippewa River
- 10 Remote Campsites Accessible by Hiking/Canoeing
- Hand Water Pump
- Sandy Swimming Beach and Boat Launch
- Great fishing & 8 miles of Hiking Trails
- 18 Hole Disc Golf Course

 All Parks are pet friendly



Isabella County Parks & Recreation Commission

200 N. Main Street, Mt. Pleasant, MI 48858

Phone: 989.772.0911 ext. 340

Fax: 989.779.9916

[parks@isabellacounty.org](mailto:parks@isabellacounty.org)

[www.isabellacounty.org/parks](http://www.isabellacounty.org/parks)



## Isabella County Campground Reservation Guide



Enjoy a summer day on the beach at  
Coldwater Lake Family Park.



Relax or take a dip at  
Herrick Recreation Area!



989.772.0911 ext. 340

[www.isabellacounty.org/park](http://www.isabellacounty.org/park)

# Reservation Application

Customer Information (please print clearly)

Camper/Group Name \_\_\_\_\_

Address \_\_\_\_\_

City \_\_\_\_\_ State \_\_\_\_\_ Zip \_\_\_\_\_

Telephone: (\_\_\_\_) \_\_\_\_\_

Isabella County Resident:  Yes  No

Please check appropriate park:

- Coldwater Lake Family Park
- Deerfield Nature Park
- Herrick Recreation Area

Campsite #: \_\_\_\_\_  
                     1st Choice      2nd Choice      3rd Choice

Arrival Date \_\_\_\_\_ Departure Date \_\_\_\_\_ Total Nights Stay \_\_\_\_\_

Number in Party: \_\_\_\_\_  
                                     Adults                      Youth

\_\_\_\_\_ X \_\_\_\_\_ = \$ \_\_\_\_\_  
 # of nights                      cost per night                      total cost

Payment Information (please check one)

- Check/Money Order (payable to: Isabella County Parks)
- Visa
- Mastercard

Credit Card # \_\_\_\_\_ Expiration Date \_\_\_\_\_

Applicant's Signature \_\_\_\_\_ Date \_\_\_\_\_

Return completed application with payment to:  
**Isabella County Parks & Recreation**  
 200 North Main Street  
 Mt. Pleasant, MI 48858

# Park Fees

Effective November 2009	County Resident	Non-County Resident
<b>Camping Fees (includes 1 vehicle permit)</b>		
Camping Fee	\$20	\$25
Camping Fee-Deerfield	\$20	\$20
Cabin Fee	\$40	\$45
Monthly Rate	\$470	\$550
Monthly Rate-Deerfield	\$400	\$485
Seasonal Camping Fee	\$1800	\$1800
<b>Vehicle Entrance Permits</b>		
Annual Permit	\$25	\$35
Daily Permit	\$6	\$6
Van (6-10 passenger-commercial)	\$10	\$10
Van/Bus (11-30 passenger)	\$15	\$15
<b>Watercraft Permits</b>		
Watercraft—Daily	\$3	\$3
Watercraft—Camper (entire stay)	\$3	\$3
Watercraft—Annual	\$10	\$10
<b>Pavilion Rental Fees</b>		
Coldwater: Hofbauer-\$75 Beach- \$50 Lakeview-\$50		
Herrick: West Pavilion-\$75 East Pavilion-\$75		
Deerfield: Fussman-\$50 West Beach, East Beach, Pond Overlook-\$30 Covered Bridge (includes vehicle entry) - \$250		



# Isabella County Campground Maps

## Coldwater Lake Family

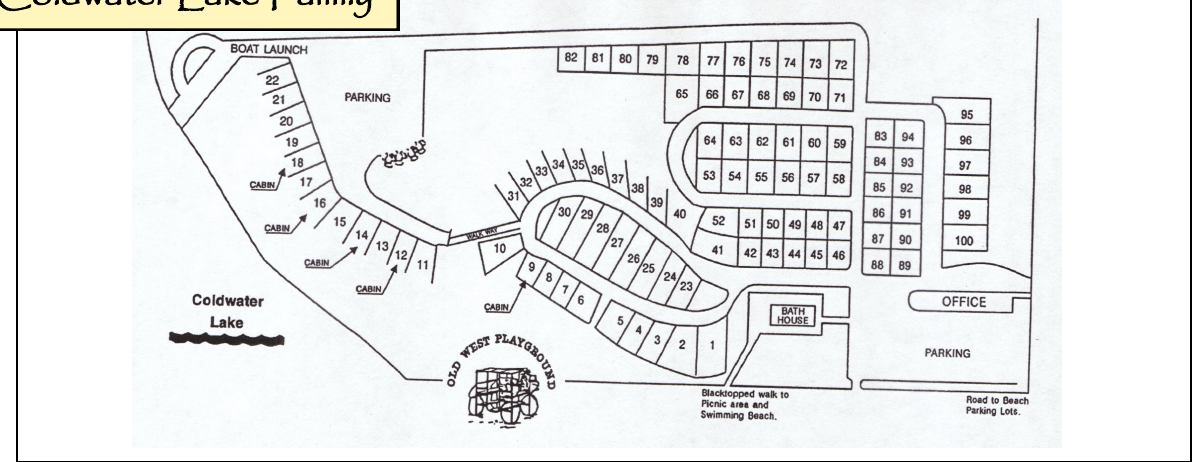

## Herrick Recreation Area

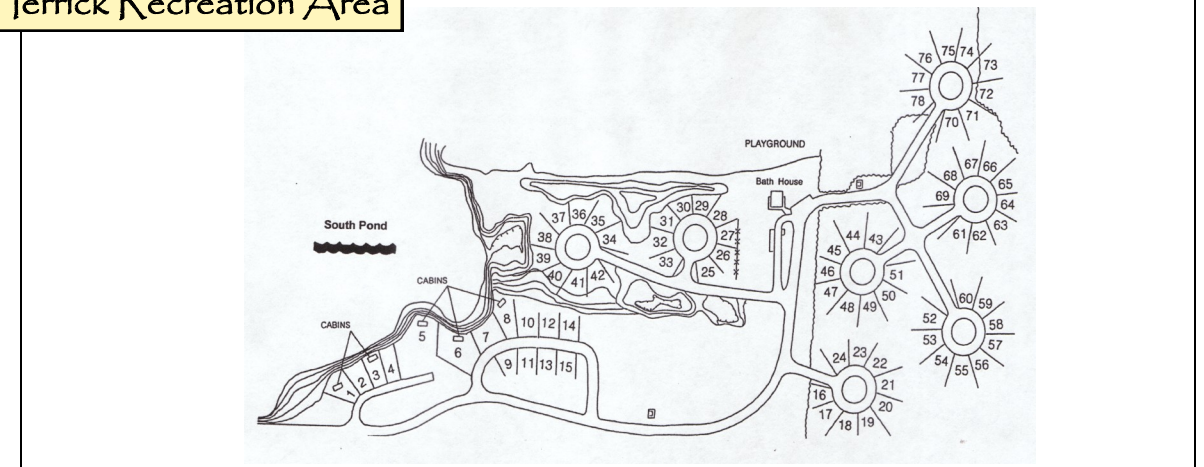

## Deerfield Nature Park

