

R E S O L U T I O N

UNIFORM HOUSE ADDRESSING ORDINANCE

- WHEREAS, *the Isabella County Board of Commissioners has established a state-of-the-art Enhanced 911/Central Dispatch operation to provide better service to Isabella County Residents, and*
- WHEREAS, *the addresses in various parts of the County are not established in a uniform and rational manner causing time delays for emergency agencies to respond to requests for service and places the general public at risk, and*
- WHEREAS, *the Isabella County Board of Commissioners has appointed a Task Force consisting of various public and private individuals throughout the County to investigate this problem, and*
- WHEREAS, *the Task Force has proposed adoption of a Uniform House Addressing Ordinance as a means of resolving the problem, and*
- WHEREAS, *a Prosecuting Attorney opinion dated August 3, 1990 states that the development of a uniform house numbering ordinance facilitates the development of 9-1-1 services and therefore the county has the authority to enact the ordinance, and*
- WHEREAS, *two public hearings on the proposed ordinance were held to allow the general public proper notification and provide an opportunity to express concerns, and*
- WHEREAS, *the Isabella County Board of Commissioners propose to establish a Uniform House Addressing Ordinance which will require a uniform and rational system for addressing residences in the County, and*
- NOW, THEREFORE, BE IT RESOLVED that the Isabella County Board of Commissioners hereby adopts the Uniform House Addressing Ordinance which shall become effective upon it's publication.

UNIFORM HOUSE-NUMBERING ORDINANCE

Isabella County Ordinance # _____

INTRODUCTION

In order to uniformly assign and maintain house numbers and provide for easy identification of those numbers for the various purposes including but not limited to the implementation of 9-1-1 service and to promote the health, safety and welfare of the citizens of the County of Isabella, the County of Isabella enacts its Uniform House-Numbering Ordinance as follows:

Section 1: THERE IS HEREBY CREATED the Isabella County Uniform House-Numbering Ordinance.

Section 2: Definitions as used in the Ordinance:

Section 2.1: House Number shall mean the number assigned to consecutive intervals along a street, road or thoroughfare pursuant to the Number Assignment Formula contained herein.

Section 2.2: The "Number Assignment Formula" as found herein is defined as follows:

Beginning from the point of origin two house numbers shall be assigned for each interval, with each interval on the right-hand side of the road as one leaves the point of origin being assigned an even number, and each interval on the left-hand side as one leaves the point of origin being assigned an odd number. The numbers assigned shall increase consecutively by equal intervals. Intervals shall run North, South, East and West as diagonally from the point of origin.

Section 2.3: As used herein, "Primary Structure" shall include but not be limited to: residential building, mobile home park, commercial building, industrial building, office building, public building, well, field pump, utility facility, lighted billboard, and lighted outdoor display/storage facility.

Section 2.4: "Interval" as used herein means a distance along a roadway, covered by this Ordinance, of 10.56 feet, there being 500 intervals per mile (5,280 feet). Intervals of greater or lesser length than 10.56 feet may be determined by dividing the actual distance of the mile section by 500.

Section 2.5: Point of Origin as used herein means the intersection of an East-West base line and a North-South base line from where all intervals begin. The North-South, East-West intersection in Isabella County shall be the intersection of Meridian Rd., and Baseline Rd.

Section 2.6: Display as used herein is the manner the house number is affixed to a structure so that it is readily identifiable pursuant to provisions of this Ordinance.

Section 2.7: Diagonal roads as used herein, are roads whose course does not run in either an approximately North-South or East-West direction.

Section 3: House Number Display

Section 3.1: Display of House Number - Each primary structure shall display a house number. A house number shall not be displayed contained numbers less than 3 inches (7.62 centimeters) in height. It shall be visible from the roadway named in the address, and all house numbers shall be in Arabic numerals. Numbered structures greater than 90 feet from the center of the road shall display numbers on the house and also on a post, mailbox, tree, etc. at the entrance of the driveway.

Section 3.2: The House Number Administration is hereby empowered to promulgate rules for house number display. Said rules shall be effective upon approval of the Isabella County Board of Commissioners. The County Board of Commissioners may adopt administrative rules and regulations in conjunction with the adoption of this ordinance.

Section 4: House Numbering Administration

Section 4.1: There is hereby created within the Equalization/Inspection Department for Isabella County a House-Numbering Administration. The Project Administrator/Drafts Person of this department shall be the director of the House-Numbering Administration and shall draft rules and regulations for the operation of the House-Numbering Administration and the assignment of house numbers for all intervals along roadways emanating from the point of origin, including diagonal roads, pursuant to this Ordinance. Said rules and regulations shall be approved by the Isabella County Board of Commissioners before they take effect.

Section 4.2: The City of Mt. Pleasant or any other city or village house numbering system shall be used to number properties along the roads which form boundaries between the city or villages and a township.

Section 4.3: The House-Numbering Administration Director shall cause to be created and maintained an accurate map of all roads within Isabella County and shall make house numbers available for each interval along the roadway. Said map shall be the official repository of said house number assignments.

Section 4.4: House numbers shall not be assigned along any public road until a name for said road has been approved by the Isabella County Road Commission. House numbers shall not be assigned along any unplatted private road or access easement of record where the name of said unplatted private road or access easement has not been registered with, and approved by, the County Road Commission. This does not mean the Road Commission is responsible for the maintenance of the private road.

Section 4.5: Existing house numbers which do not comply with the Isabella County House-Numbering System shall be changed either at the request of the property owner or his or her agent(s) upon approval of the House-Numbering Administration or such change shall be initiated by the County. When a change is initiated by the County, the property owner shall be notified, in writing, 30 days prior to the time the new number shall become the official number for the interval(s) of the property in question. It shall be a violation of this ordinance to use a number other than the number provided by the House-Numbering Administration.

Section 4.6: The Director shall, upon application by a landowner, assign a house number and approve the display; provided said display is consistent with the provisions for display as contained herein.

Section 5: Enforcement

Section 5.1: A violation of the provisions of this Ordinance shall be punishable by a fine of not more than \$50.00 or imprisonment for not more than one (1) day, or both such fine and imprisonment, and each day that a violation occurs shall be deemed a separate offense.

Section 5.2: When the House-Numbering Administration Director learns of a violation of this ordinance he shall send a notice in writing to the alleged violator requesting compliance with the provisions of this ordinance. If the alleged violator does not comply with the ordinance within fifteen days from the date the written notice is mailed, then the House-Numbering Administrator may seek the institution of legal proceedings to enforce the ordinance.

Section 6: Miscellaneous

Section 6.1: Except as otherwise provided herein this Ordinance shall affect only property located along roadways found in the unincorporated areas within the County of Isabella, and shall not be deemed effective as to property located within the boundaries of an incorporated village or city within Isabella County.

Section 6.2: No portion of this Ordinance shall be applied so as to interfere with the activities of any city, township or village, and shall any application of the provisions of this Ordinance interfere with any affair of any city, village or township within Isabella County, said application shall be void and of no effect.

Section 6.3: The provisions of this ordinance are separable, and the invalidity of any phrase, clause or part of this ordinance shall not affect the validity or effectiveness of the remainder of the ordinance.

Section 6.4: This Ordinance shall take effect when notice of the adoption is published in a newspaper of general circulation in the County.

Authenticated By:

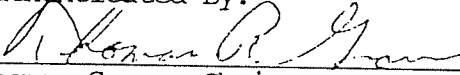
Thomas Gross, Chairman
Isabella County Board of
Commissioners

Attested By:

Betty Prout
County Clerk

Effective Date: _____

ADMINISTRATIVE RULES AND REGULATIONS

for the

ISABELLA COUNTY UNIFORM HOUSE-NUMBERING SYSTEM

In order to uniformly assign and maintain house numbers and provide for easy identification of those numbers for the various purposes including but not limited to the implementation of 9-1-1 service and to promote the health, safety and welfare of the citizens of the County of Isabella, the Isabella County Board of Commissioners approves the Administrative Rules and regulations for the Uniform House-Numbering System.

APPLICATION OF HOUSE-NUMBERING SYSTEM

The Administrative Rules and Regulations shall affect only property located along roadways found in the unincorporated areas within the County of Isabella, and shall not be deemed effective as to property located within the boundaries of an incorporated village or city within Isabella County.

1. DEFINITIONS

- A. Agent: A property owner's authorized agent is an attorney, trustee, realtor, broker, purchaser, tenant, or receiver.
- B. Diagonal Road: A diagonal road is a road whose course does not run in either an approximate North-South or East-West direction.
- C. Display: Display is the manner the house number is affixed to a structure so that it is readily identifiable pursuant to the provisions of these rules.
- D. House Number: House Number shall mean the number assigned to primary structures at consecutive intervals along a street.
- E. Interval (or Frontage Unit): Interval is a distance along a roadway of 10.56 feet, except as may be determined by the House-Numbering Administration Director along diagonal roads, curvilinear streets, circle streets, loop streets or for buildings in group housing projects, business and industrial districts and prenumbered subdivision plats of record. Intervals of greater or lesser length than 10.56 feet may be determined by dividing the actual distance of the mile section by 500.
- F. Point of Origin: Point of origin is the intersection of an East-West base line and a North-South base line from where all intervals begin. The North-South, East-West base line intersection in Isabella County shall be the intersection of Baseline Road and Meridian Road.
- G. Primary Structure: Primary structure shall include but not be limited to: residential building, mobile home park, commercial building, industrial building, office building, public building, well, field pump, utility facility, lighted billboard, and lighted outdoor display/storage facility.

H. Private access or easement: Any road, street or thoroughfare which more than one primary structure.

2. DISPLAY OF HOUSE NUMBER

A house number shall not be displayed containing numbers less than 3 inches in height. It shall be visible from the roadway named in the address, and all house numbers shall be in Arabic numerals (i.e. block print). When the structure (house/building) is more than 90 feet back from the road, or the view of the structure is blocked by trees or shrubs or another structure, the house number shall be on a sign or attached to a tree, fence, post, or mailbox within 10 feet of the driveway and not more than 20 feet from the road with the following exception: Mailboxes that are grouped shall not be used for displaying house numbers as defined in these rules, as grouped mailboxes block the view of house numbers and/or do not provide identification of the location of residences.

3. MAPPED NUMBERS

The House-Numbering Administration Director shall cause to be created and maintained an accurate map of all roads within Isabella County and shall make house numbers available for each interval along the roadway. Said map shall be the official repository of said house number assignments.

4. ASSIGNING AND CHANGING HOUSE NUMBERS

The House-Numbering Administration Director shall, upon application by a land owner or his/her authorized agent, assign a house number and approve the display; provided same is consistent with the provision of these rules. Existing house numbers which do not comply with the Isabella County House-Numbering System shall be changed either by request of the property owner and his/her authorized agents through the House-Numbering Administration at no charge or such change shall be initiated by the County. When a change is initiated by the County, the property owner shall be notified in writing 30 days prior to the time the new number shall become the official number for the interval(s) of property in question.

5. NEW HOUSE NUMBER FEE:

The fee will be determined by the Isabella County Board of Commissioners.

6. OFFICIAL STREET/ROAD NAME

House numbers shall not be assigned along any public road whose name has not been approved by the Isabella County Road Commission. House numbers shall not be assigned along any unplatted private road or access easement of record whose name has not been registered with and approved by the County Road Commission. The Road Commission shall notify, in writing, the House-Numbering Administration when a road, private road or access easement has been named.

7. PROCEDURE FOR CALCULATING PROPER HOUSE NUMBERS

Beginning from the point of origin, two house numbers shall be assigned for interval, with each interval on the right-hand side of the roadway as one leaves the point of origin being assigned an even number, and each interval on the left-hand side as one leaves the point of origin being assigned an odd number. The numbers

assigned shall increase consecutively by an increment of two (2) for each interval, running North, South, East and West from the point of origin.

Fractions shall not be used in assigning house numbers.

For standard mile sections (5,280 feet), an interval of 10.56 shall be used. Using the county record maps, the house number will be assigned by first determining the nearest mile road or section line between the structure and the transacting base line. The distance between the front door of the primary structure and the mile road/section line will be measured and the corresponding house number as given in Table 1 will be assigned.

The corresponding odd or even number in the table will be added to the mile section range number and issued to the property owner.

For mile sections that are longer or shorter than the standard length of 5,280 feet, the interval footage shall be determined by dividing the actual distance of the mile section by 500.

8. CITY OF MT. PLEASANT SYSTEM

The City of Mt. Pleasant or any other city or village's house-numbering system shall be used to number properties along the roads which form boundaries between the city or village and a township regardless of whether the property being numbered is located within the city or village's boundaries or within a township's boundaries.

9. PRENUMBERED RECORDED SUBDIVISION PLATS

As a general principle, single-family residential subdivision plats of record may be prenumbered by the House-Numbering Administration Director in accordance with these rules.

10. CORNER LOTS

The rule to apply when assigning a number to a building on a corner lot is to assign a number from the street upon which the front entrance faces. Dual addresses shall be avoided.

11. PROCEDURE FOR ISSUING HOUSE NUMBERS ALONG DIAGONAL MEANDERING OR CURVILINEAR ROADS

Where the road does not run directly North-South or East-West, the general course of the road is to be used in determining the house-numbering direction. A footage more or less than the 10.56 foot figure must be used in determining the proper house number interval. The correct base interval is obtained by dividing the actual distance of the road by 500.

A house number interval will be determined by dividing the feet a house is from the point of origin by the base interval for a particular road. (See table II for the formula).

12. NUMBERING ALONG STREETS STARTING FROM DIFFERENT POINTS ON THE SAME CROSS STREET

When a street does not begin at the same location as a parallel street, the house number shall begin with the same house number measured from the base line as on the parallel street.

13. NUMBERING ON CIRCLE STREETS AND HORSESHOE-SHAPED STREETS

Properties along circle streets, loop streets and horseshoe-shaped streets shall be numbered in consecutive order, pursuant to the procedure for calculating proper house numbers with the even numbers on the inside of the circle and the odd numbers on the outside of the circle.

14. NUMBERING WHEN THE STREETS CHANGE DIRECTION

If a street changes direction at a 60 degree angle or more and for a length of 300 feet or more, the numbering along the street shall be changed to reflect the orientation with a different baseline.

15. NUMBERING APARTMENT AND CONDOMINIUMS

Individual apartment buildings and group housing projects shall have one address number. Individual dwellings within the apartment buildings shall be assigned suffix letters or numerals by the apartment building management. House numbers shall be assigned to the buildings where a driveway or court joins the street. House number shall be the street address of all units which face upon the driveway (interior court).

16. NUMBERING BUILDINGS IN BUSINESS AND INDUSTRIAL DISTRICTS

In a business and industrial district, each building facing the roadway, court or plaza shall have its own designated address number.

17. NUMBERING DUPLEX BUILDINGS

Separate house numbers shall be assigned to the entrances of a duplex house, for an upstairs dwelling which has an outside entrance, and for separate duplex buildings in the rear of other buildings.

18. NUMBERING MOBILE HOME PARKS

Mobile home parks shall have one address number. Individual mobile home spaces or lots within the park shall be assigned lot numbers or numerals by the mobile home park management. The management shall cause to be displayed, the lot number of each lot as defined in these rules and regulations.

19. NUMBERING LANDLOCKED PROPERTY

The procedure for calculating proper house numbers shall be used for numbering houses and buildings on landlocked properties. Private driveways and unimproved roads that service landlocked properties shall be given a name that is registered with and approved by the County Road Commission.

20. NUMBERING OFFICE SUITES

Office suite buildings shall have one address number. Individual suites within the office buildings shall be assigned suffix letters or numerals by the office building management.

21. SUFFIX LETTERS AND NUMERALS

Suffix letters and/or numerals assigned to dwellings, mobile home lots, office suites, and other buildings divided into address units shall first be registered with and approved by the House-Numbering Administration Director.

22. EQUALIZATION/INSPECTION PERSONNEL

In the Equalization/Inspection department the existing personnel will continue to assist in house-numbering on an as time permits basis.

TABLE 1

HOUSE-NUMBERING

(1000 no. per mile)

(table is based on 5280 ft. per mile)

INV	FOOTAGE	HOUSE NO.	FOOTAGE	HOUSE NO.	INV.
---	-----	-----	-----	-----	-----
1	0 - 11	1 & 2	529 - 539	101 & 102	51
2	12 - 21	3 & 4	540 - 549	103 & 104	52
3	22 - 32	5 & 6	550 - 560	105 & 106	53
4	33 - 42	7 & 8	561 - 570	107 & 108	54
5	43 - 53	9 & 10	571 - 581	109 & 110	55
6	54 - 63	11 & 12	582 - 591	111 & 112	56
7	64 - 74	13 & 14	592 - 602	113 & 114	57
8	75 - 84	15 & 16	603 - 612	115 & 116	58
9	85 - 95	17 & 18	613 - 623	117 & 118	59
10	96 - 106	19 & 20	624 - 634	119 & 120	60
11	107 - 116	21 & 22	635 - 644	121 & 122	61
12	117 - 127	23 & 24	645 - 655	123 & 124	62
13	128 - 137	25 & 26	656 - 665	125 & 126	63
14	138 - 148	27 & 28	666 - 676	127 & 128	64
15	149 - 158	29 & 30	677 - 686	129 & 130	65
16	159 - 169	31 & 32	687 - 697	131 & 132	66
17	170 - 180	33 & 34	698 - 708	133 & 134	67
18	181 - 190	35 & 36	709 - 718	135 & 136	68
19	191 - 201	37 & 38	719 - 729	137 & 138	69
20	202 - 211	39 & 40	730 - 739	139 & 140	70
21	212 - 222	41 & 42	740 - 750	141 & 142	71
22	223 - 232	43 & 44	751 - 760	143 & 144	72
23	233 - 243	45 & 46	761 - 771	145 & 146	73
	244 - 253	47 & 48	772 - 781	147 & 148	74
	254 - 264	49 & 50	782 - 792	149 & 150	75
26	265 - 275	51 & 52	793 - 803	151 & 152	76
27	276 - 285	53 & 54	804 - 813	153 & 154	77
28	286 - 296	55 & 56	814 - 824	155 & 156	78
29	297 - 306	57 & 58	825 - 834	157 & 158	79
30	307 - 317	59 & 60	835 - 845	159 & 160	80
31	318 - 327	61 & 62	846 - 855	161 & 162	81
32	328 - 338	63 & 64	856 - 866	163 & 164	82
33	339 - 348	65 & 66	867 - 876	165 & 166	83
34	349 - 359	67 & 68	877 - 887	167 & 168	84
35	360 - 370	69 & 70	888 - 898	169 & 170	85
36	371 - 380	71 & 72	899 - 908	171 & 172	86
37	381 - 391	73 & 74	909 - 919	173 & 174	87
38	392 - 401	75 & 76	920 - 929	175 & 176	88
39	402 - 412	77 & 78	930 - 940	177 & 178	89
40	413 - 422	79 & 80	941 - 950	179 & 180	90
41	423 - 433	81 & 82	951 - 961	181 & 182	91
42	434 - 444	83 & 84	962 - 972	183 & 184	92
43	445 - 454	85 & 86	973 - 982	185 & 186	93
44	455 - 465	87 & 88	983 - 993	187 & 188	94
45	466 - 475	89 & 90	994 - 1003	189 & 190	95
46	476 - 486	91 & 92	1004 - 1014	191 & 192	96
47	487 - 496	93 & 94	1015 - 1024	193 & 194	97
48	497 - 507	95 & 96	1025 - 1035	195 & 196	98
49	508 - 517	97 & 98	1036 - 1045	197 & 198	99
	518 - 528	99 & 100	1046 - 1056	199 & 200	100

TABLE 1 CONTINUED

INV.	FOOTAGE	HOUSE NO.	FOOTAGE	HOUSE NO.	INV.	
101	1057	-1067	201 & 202	1585 -1595	301 & 302	151
102	1068	-1077	203 & 204	1596 -1605	303 & 304	152
103	1078	-1088	205 & 206	1606 -1616	305 & 306	153
104	1089	-1098	207 & 208	1617 -1626	307 & 308	154
105	1099	-1109	209 & 210	1627 -1637	309 & 310	155
106	1110	-1119	211 & 212	1638 -1647	311 & 312	156
107	1120	-1130	213 & 214	1648 -1658	313 & 314	157
108	1131	-1140	215 & 216	1659 -1668	315 & 316	158
109	1141	-1151	217 & 218	1669 -1679	317 & 318	159
110	1152	-1162	219 & 220	1680 -1690	319 & 320	160
111	1163	-1172	221 & 222	1691 -1700	321 & 322	161
112	1173	-1183	223 & 224	1701 -1711	323 & 324	162
113	1184	-1193	225 & 226	1712 -1721	325 & 326	163
114	1194	-1204	227 & 228	1722 -1732	327 & 328	164
115	1205	-1214	229 & 230	1733 -1742	329 & 330	165
116	1215	-1225	231 & 232	1743 -1753	331 & 332	166
117	1226	-1236	233 & 234	1754 -1764	333 & 334	167
118	1237	-1246	235 & 236	1765 -1774	335 & 336	168
119	1247	-1257	237 & 238	1775 -1785	337 & 338	169
120	1258	-1267	239 & 240	1786 -1795	339 & 340	170
121	1268	-1278	241 & 242	1796 -1806	341 & 342	171
122	1279	-1288	243 & 244	1807 -1816	343 & 344	172
123	1289	-1299	245 & 246	1817 -1827	345 & 346	173
124	1300	-1309	247 & 248	1828 -1837	347 & 348	174
125	1310	-1320	249 & 250	1838 -1848	349 & 350	175
126	1321	-1331	251 & 252	1849 -1859	351 & 352	176
127	1332	-1341	253 & 254	1860 -1869	353 & 354	177
128	1342	-1352	255 & 256	1870 -1880	355 & 356	178
129	1353	-1362	257 & 258	1881 -1890	357 & 358	179
130	1363	-1373	259 & 260	1891 -1901	359 & 360	180
131	1374	-1383	261 & 262	1902 -1911	361 & 362	181
132	1384	-1394	263 & 264	1912 -1922	363 & 364	182
133	1395	-1404	265 & 266	1923 -1932	365 & 366	183
134	1405	-1415	267 & 268	1933 -1943	367 & 368	184
135	1416	-1426	269 & 270	1944 -1954	369 & 370	185
136	1427	-1436	271 & 272	1955 -1964	371 & 372	186
137	1437	-1447	273 & 274	1965 -1975	373 & 374	187
138	1448	-1457	275 & 276	1976 -1985	375 & 376	188
139	1458	-1468	277 & 278	1986 -1996	377 & 378	189
140	1469	-1478	279 & 280	1997 -2006	379 & 380	190
141	1479	-1489	281 & 282	2007 -2017	381 & 382	191
142	1490	-1500	283 & 284	2018 -2028	383 & 384	192
143	1501	-1510	285 & 286	2029 -2038	385 & 386	193
144	1511	-1521	287 & 288	2039 -2049	387 & 388	194
145	1522	-1531	289 & 290	2050 -2059	389 & 390	195
146	1532	-1542	291 & 292	2060 -2070	391 & 392	196
147	1543	-1552	293 & 294	2071 -2080	393 & 394	197
148	1553	-1563	295 & 296	2081 -2091	395 & 396	198
149	1564	-1573	297 & 298	2092 -2101	397 & 398	199
150	1574	-1584	299 & 300	2102 -2112	399 & 400	200

TABLE 1 CONTINUED

INV.	FOOTAGE	HOUSE NO.	FOOTAGE	HOUSE NO.	INV.		
201	2113	-2123	401 & 402	2641	-2651	501 & 502	251
202	2124	-2133	403 & 404	2652	-2661	503 & 504	252
203	2134	-2144	405 & 406	2662	-2672	505 & 506	253
204	2145	-2154	407 & 408	2673	-2682	507 & 508	254
205	2155	-2165	409 & 410	2683	-2693	509 & 510	255
206	2166	-2175	411 & 412	2694	-2703	511 & 512	256
207	2176	-2186	413 & 414	2704	-2714	513 & 514	257
208	2187	-2196	415 & 416	2715	-2724	515 & 516	258
209	2197	-2207	417 & 418	2725	-2735	517 & 518	259
210	2208	-2218	419 & 420	2736	-2746	519 & 520	260
211	2219	-2228	421 & 422	2747	-2756	521 & 522	261
212	2229	-2239	423 & 424	2757	-2767	523 & 524	262
213	2240	-2249	425 & 426	2768	-2777	525 & 526	263
214	2250	-2260	427 & 428	2778	-2788	527 & 528	264
215	2261	-2270	429 & 430	2789	-2798	529 & 530	265
216	2271	-2281	431 & 432	2799	-2809	531 & 532	266
217	2282	-2292	433 & 434	2810	-2820	533 & 534	267
218	2293	-2302	435 & 436	2821	-2830	535 & 536	268
219	2303	-2313	437 & 438	2831	-2841	537 & 538	269
220	2314	-2323	439 & 440	2842	-2851	539 & 540	270
221	2324	-2334	441 & 442	2852	-2862	541 & 542	271
222	2335	-2344	443 & 444	2863	-2872	543 & 544	272
223	2345	-2355	445 & 446	2873	-2883	545 & 546	273
224	2356	-2365	447 & 448	2884	-2893	547 & 548	274
225	2366	-2376	449 & 450	2894	-2904	549 & 550	275
226	2377	-2387	451 & 452	2905	-2915	551 & 552	276
227	2388	-2397	453 & 454	2916	-2925	553 & 554	277
228	2398	-2408	455 & 456	2926	-2936	555 & 556	278
229	2409	-2418	457 & 458	2937	-2946	557 & 558	279
230	2419	-2429	459 & 460	2947	-2957	559 & 560	280
231	2430	-2439	461 & 462	2958	-2967	561 & 562	281
232	2440	-2450	463 & 464	2968	-2978	563 & 564	282
233	2451	-2460	465 & 466	2979	-2988	565 & 566	283
234	2461	-2471	467 & 468	2989	-2999	567 & 568	284
235	2472	-2482	469 & 470	3000	-3010	569 & 570	285
236	2483	-2492	471 & 472	3011	-3020	571 & 572	286
237	2493	-2503	473 & 474	3021	-3031	573 & 574	287
238	2504	-2513	475 & 476	3032	-3041	575 & 576	288
239	2514	-2524	477 & 478	3042	-3052	577 & 578	289
240	2525	-2534	479 & 480	3053	-3062	579 & 580	290
241	2535	-2545	481 & 482	3063	-3073	581 & 582	291
242	2546	-2556	483 & 484	3074	-3084	583 & 584	292
243	2557	-2566	485 & 486	3085	-3094	585 & 586	293
244	2567	-2577	487 & 488	3095	-3105	587 & 588	294
245	2578	-2587	489 & 490	3106	-3115	589 & 590	295
246	2588	-2598	491 & 492	3116	-3126	591 & 592	296
247	2599	-2608	493 & 494	3127	-3136	593 & 594	297
248	2609	-2619	495 & 496	3137	-3147	595 & 596	298
249	2620	-2629	497 & 498	3148	-3157	597 & 598	299
250	2630	-2640	499 & 500	3158	-3168	599 & 600	300

TABLE 1 CONTINUED

INV.	FOOTAGE	HOUSE NO.	FOOTAGE	HOUSE NO.	INV.
301	3169	-3178	601 & 602	701 & 702	351
302	3180	-3189	603 & 604	703 & 704	352
303	3190	-3200	605 & 606	705 & 706	353
304	3201	-3210	607 & 608	707 & 708	354
305	3211	-3221	609 & 610	709 & 710	355
306	3222	-3231	611 & 612	711 & 712	356
307	3232	-3242	613 & 614	713 & 714	357
308	3243	-3252	615 & 616	715 & 716	358
309	3253	-3263	617 & 618	717 & 718	359
310	3264	-3274	619 & 620	719 & 720	360
311	3275	-3284	621 & 622	721 & 722	361
312	3285	-3295	623 & 624	723 & 724	362
313	3296	-3305	625 & 626	725 & 726	363
314	3306	-3316	627 & 628	727 & 728	364
315	3317	-3326	629 & 630	729 & 730	365
316	3327	-3337	631 & 632	731 & 732	366
317	3338	-3348	633 & 634	733 & 734	367
318	3349	-3358	635 & 636	735 & 736	368
319	3359	-3369	637 & 638	737 & 738	369
320	3370	-3379	639 & 640	739 & 740	370
321	3380	-3390	641 & 642	741 & 742	371
322	3391	-3400	643 & 644	743 & 744	372
323	3401	-3411	645 & 646	745 & 746	373
324	3412	-3421	647 & 648	747 & 748	374
325	3422	-3432	649 & 650	749 & 750	375
326	3433	-3443	651 & 652	751 & 752	376
327	3444	-3453	653 & 654	753 & 754	377
328	3454	-3464	655 & 656	755 & 756	378
329	3465	-3474	657 & 658	757 & 758	379
330	3475	-3485	659 & 660	759 & 760	380
331	3486	-3495	661 & 662	761 & 762	381
332	3496	-3506	663 & 664	763 & 764	382
333	3507	-3516	665 & 666	765 & 766	383
334	3517	-3527	667 & 668	767 & 768	384
335	3528	-3538	669 & 670	769 & 770	385
336	3539	-3548	671 & 672	771 & 772	386
337	3549	-3559	673 & 674	773 & 774	387
338	3560	-3569	675 & 676	775 & 776	388
339	3570	-3580	677 & 678	777 & 778	389
340	3581	-3590	679 & 680	779 & 780	390
341	3591	-3601	681 & 682	781 & 782	391
342	3602	-3612	683 & 684	783 & 784	392
343	3613	-3622	685 & 686	785 & 786	393
344	3623	-3633	687 & 688	787 & 788	394
345	3634	-3643	689 & 690	789 & 790	395
346	3644	-3654	691 & 692	791 & 792	396
347	3655	-3664	693 & 694	793 & 794	397
348	3665	-3675	695 & 696	795 & 796	398
349	3676	-3685	697 & 698	797 & 798	399
350	3686	-3696	699 & 700	799 & 800	400
			3697 -3707		
			3708 -3717		
			3718 -3728		
			3729 -3738		
			3739 -3749		
			3750 -3759		
			3760 -3770		
			3771 -3780		
			3781 -3791		
			3792 -3802		
			3803 -3812		
			3813 -3823		
			3824 -3833		
			3834 -3844		
			3845 -3854		
			3855 -3865		
			3866 -3876		
			3877 -3886		
			3887 -3897		
			3898 -3907		
			3908 -3918		
			3919 -3928		
			3929 -3939		
			3940 -3949		
			3950 -3960		
			3961 -3971		
			3972 -3981		
			3982 -3992		
			3993 -4002		
			4003 -4013		
			4014 -4023		
			4024 -4034		
			4035 -4044		
			4045 -4055		
			4056 -4066		
			4067 -4076		
			4077 -4087		
			4088 -4097		
			4098 -4108		
			4109 -4118		
			4119 -4129		
			4130 -4140		
			4141 -4150		
			4151 -4161		
			4162 -4171		
			4172 -4182		
			4183 -4192		
			4193 -4203		
			4204 -4213		
			4214 -4224		

TABLE 1 CONTINUED

INV.	FOOTAGE	HOUSE NO.	FOOTAGE	HOUSE NO.	INV.
401	4225 -4234	801 & 802	4753 -4763	901 & 902	451
402	4236 -4245	803 & 804	4764 -4773	903 & 904	452
403	4246 -4255	805 & 806	4774 -4784	905 & 906	453
404	4257 -4266	807 & 808	4785 -4794	907 & 908	454
405	4267 -4276	809 & 810	4795 -4805	909 & 910	455
406	4278 -4287	811 & 812	4806 -4815	911 & 912	456
407	4288 -4297	813 & 814	4816 -4826	913 & 914	457
408	4299 -4308	815 & 816	4827 -4836	915 & 916	458
409	4309 -4319	817 & 818	4837 -4847	917 & 918	459
410	4320 -4329	819 & 820	4848 -4858	919 & 920	460
411	4331 -4340	821 & 822	4859 -4868	921 & 922	461
412	4341 -4350	823 & 824	4869 -4879	923 & 924	462
413	4352 -4361	825 & 826	4880 -4889	925 & 926	463
414	4362 -4371	827 & 828	4890 -4900	927 & 928	464
415	4373 -4382	829 & 830	4901 -4910	929 & 930	465
416	4383 -4392	831 & 832	4911 -4921	931 & 932	466
417	4394 -4403	833 & 834	4922 -4932	933 & 934	467
418	4405 -4414	835 & 836	4933 -4942	935 & 936	468
419	4415 -4424	837 & 838	4943 -4953	937 & 938	469
420	4426 -4435	839 & 840	4954 -4963	939 & 940	470
421	4436 -4445	841 & 842	4964 -4974	941 & 942	471
422	4447 -4456	843 & 844	4975 -4984	943 & 944	472
423	4457 -4466	845 & 846	4985 -4995	945 & 946	473
424	4468 -4477	847 & 848	4996 -5005	947 & 948	474
4	4478 -4488	849 & 850	5006 -5016	949 & 950	475
426	4489 -4498	851 & 852	5017 -5027	951 & 952	476
427	4500 -4509	853 & 854	5028 -5037	953 & 954	477
428	4510 -4519	855 & 856	5038 -5048	955 & 956	478
429	4521 -4530	857 & 858	5049 -5058	957 & 958	479
430	4531 -4540	859 & 860	5059 -5069	959 & 960	480
431	4542 -4551	861 & 862	5070 -5079	961 & 962	481
432	4552 -4561	863 & 864	5080 -5090	963 & 964	482
433	4563 -4572	865 & 866	5091 -5100	965 & 966	483
434	4573 -4583	867 & 868	5101 -5111	967 & 968	484
435	4584 -4593	869 & 870	5112 -5122	969 & 970	485
436	4595 -4604	871 & 872	5123 -5132	971 & 972	486
437	4605 -4614	873 & 874	5133 -5143	973 & 974	487
438	4616 -4625	875 & 876	5144 -5153	975 & 976	488
439	4626 -4635	877 & 878	5154 -5164	977 & 978	489
440	4637 -4646	879 & 880	5165 -5174	979 & 980	490
441	4647 -4656	881 & 882	5175 -5185	981 & 982	491
442	4658 -4667	883 & 884	5186 -5196	983 & 984	492
443	4669 -4678	885 & 886	5197 -5206	985 & 986	493
444	4679 -4688	887 & 888	5207 -5217	987 & 988	494
445	4690 -4699	889 & 890	5218 -5227	989 & 990	495
446	4700 -4709	891 & 892	5228 -5238	991 & 992	496
447	4711 -4720	893 & 894	5239 -5248	993 & 994	497
448	4721 -4730	895 & 896	5249 -5259	995 & 996	498
449	4732 -4741	897 & 898	5260 -5269	997 & 998	499
450	4742 -4752	899 & 900	5270 -5280	999 & 1000	500

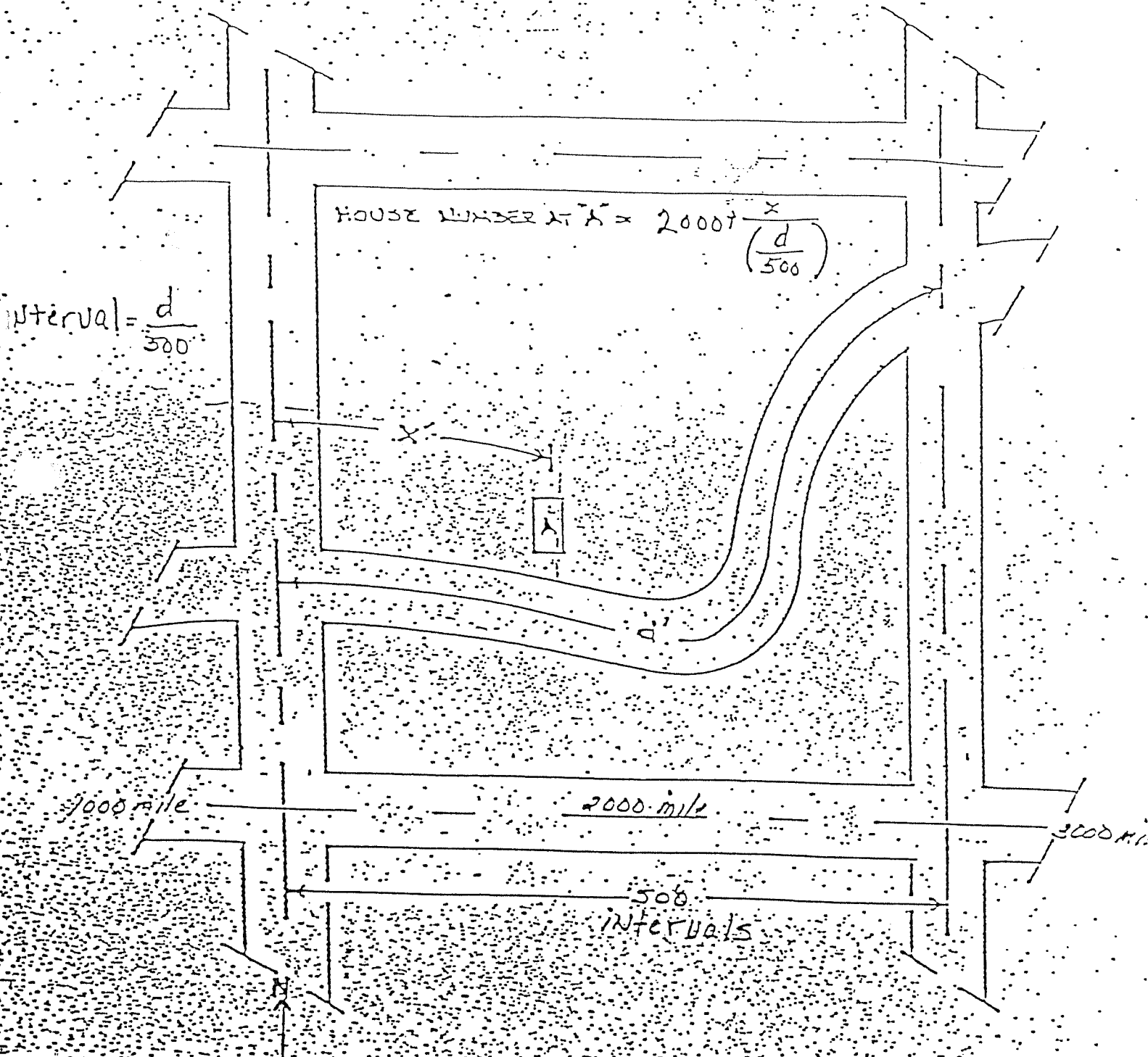

PROCEDURE FOR DETERMINING
 HOUSE NUMBERS ALONG
 DIAGONAL, MEANDERING OR
 CURVILINEAR ROADS