

**ISABELLA COUNTY  
APPLICATION FOR SITE PLAN REVIEW**

**Applicant**

Name: Simon Yoder Owner/Agent/Other interest (circle one)  
Address: 9732 S. Sherman Rd. Blanchard MI  
Phone: \_\_\_\_\_ Fax: \_\_\_\_\_

**Property Owner (if different from applicant)**

Name: Simon Yoder  
Address: \_\_\_\_\_  
Phone: \_\_\_\_\_ Fax: \_\_\_\_\_

**Property Location**

Tax ID Number: 12-019-40-001-00  
Job Site Address: 9732 S. Sherman Rd Blanchard MI  
Township: Rolland Section: 19 Zoning District: \_\_\_\_\_  
Detailed Description of Use: Saw mill

Signature: Simon Yoder Date: 3-17-2020

**NOTE:** All information received by this department is subject to the Freedom of Information Act. Under this Act, persons are allowed to request copies of said information. This includes, but not limited to, all copyrighted drawings/blueprints.

**\*OFFICE USE ONLY\***

File #: SPR 20-0006 Fee: \$ 125.00 Check #: 1708 Receipt #: 5456

Date Received: Apr 2, 2020 Received by: \_\_\_\_\_

Review Type: Zoning Administrator / Planning Commission Approved [ ] Denied [ ]

Conditions (if any): \_\_\_\_\_

Isabella County Zoning Administrator \_\_\_\_\_

Date \_\_\_\_\_

Scale: 1 SQ = 10'

96' x 40'  
BARN

Approx 1600' to west prop. line

20' x 30'  
SCRAP

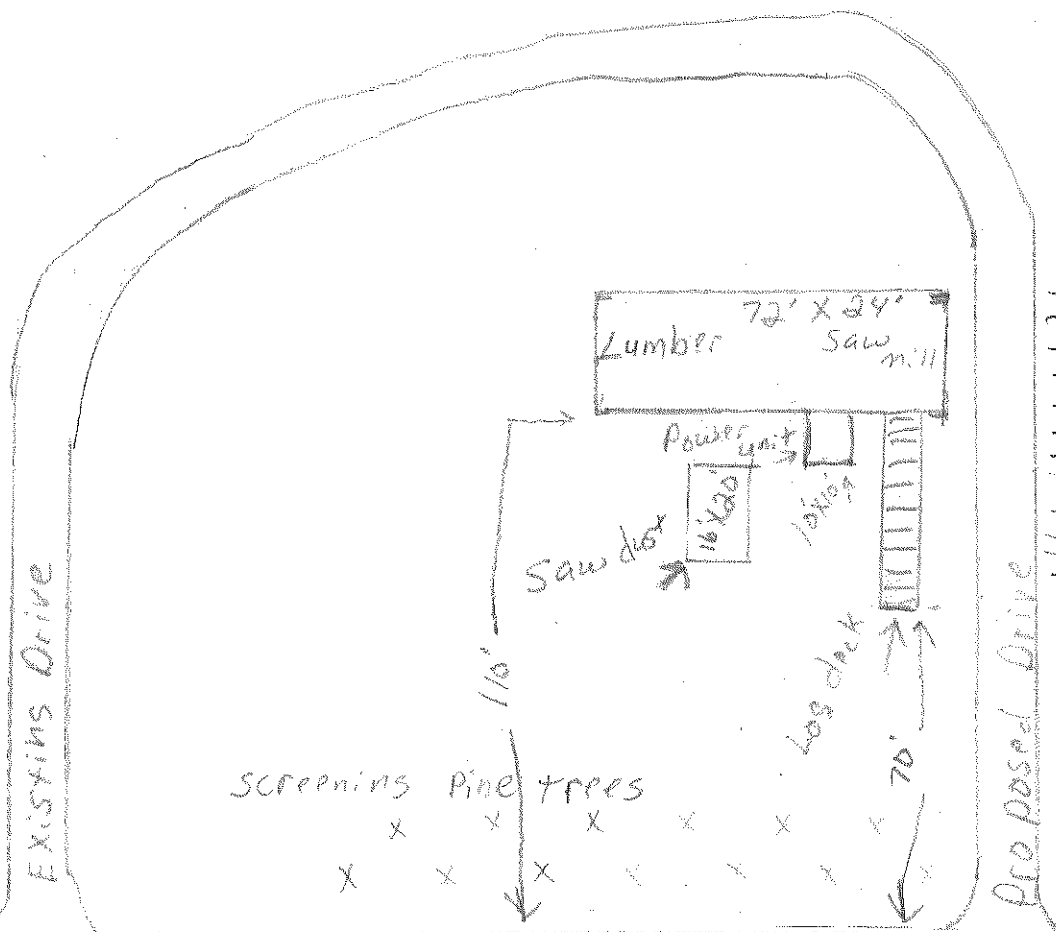

← Log storage

Approx. 800' to prop. line

North property line

WAY

← 66' →

West property line

Fre mont Rd. South property line

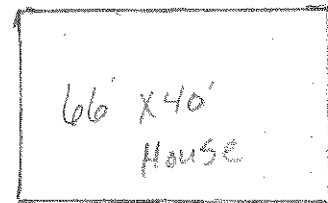
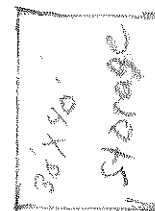
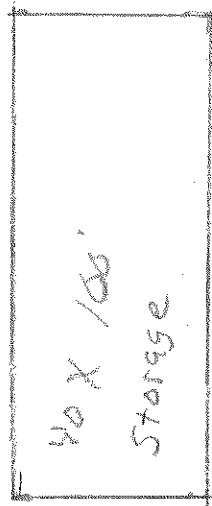

Approx 1000' to prop line

EXISTING DRIVE

EXISTING DRIVE

← 66' →

Sherman Rd.

Right of