

**ISABELLA COUNTY**  
**Application for Special Use Permit**

**Applicant:**

Name Patrick Marchiano Owner/Agent/Other interest  
Address 5879 Gross Dr. Weidman, MI 48893  
Phone (989) 330-0116 Email patshoney@hotmail.com

**Property Owner: (if different from applicant)**

Name \_\_\_\_\_  
Address \_\_\_\_\_  
Phone \_\_\_\_\_

**Property Location:**

Township Nottawa Section 19 Zoning District C-1  
Address 5254 W. Weidman Rd Weidman, MI 48893  
Tax I.D. Number 11-019-20-001-09

**Description of Project and Proposed Use (Attach additional pages if necessary):**

Mini Storage Units

Pat Marchiano  
Signature of Applicant

11/11/23  
Date

**Optional:** I hereby grant permission for members of the Isabella County Planning Commission and Zoning Administrator to enter the above-described property for the purposes of gathering information related to this application.

Pat Marchiano  
Signature of Applicant

11/11/23  
Date

**NOTE:** All information received by this department is subject to the Freedom of Information Act. Under this Act, persons are allowed to request copies of said information. This includes, but not limited to, all copyrighted drawings/blueprints.

**Office Use Only**

File No. BUP23-04 Fee \$175.00 Check # CASH Receipt No. 12753  
Date Application Received 11-14-23 Application Received By RS/MP  
Legal Description Attached? ☒ YES NO Site Plan Attached? ☒ YES NO  
Applicable Ordinance Section(s) 12.05 y

11/11/23



scale:  $1\frac{1}{2}'' = 100 \text{ FT.}$

prepared by:  
Pat Marchiando  
5879 Gross Dr.  
Weidman, MI  
48893

owner: same as above

Commercial  
Property  
Weidman Mini Storage

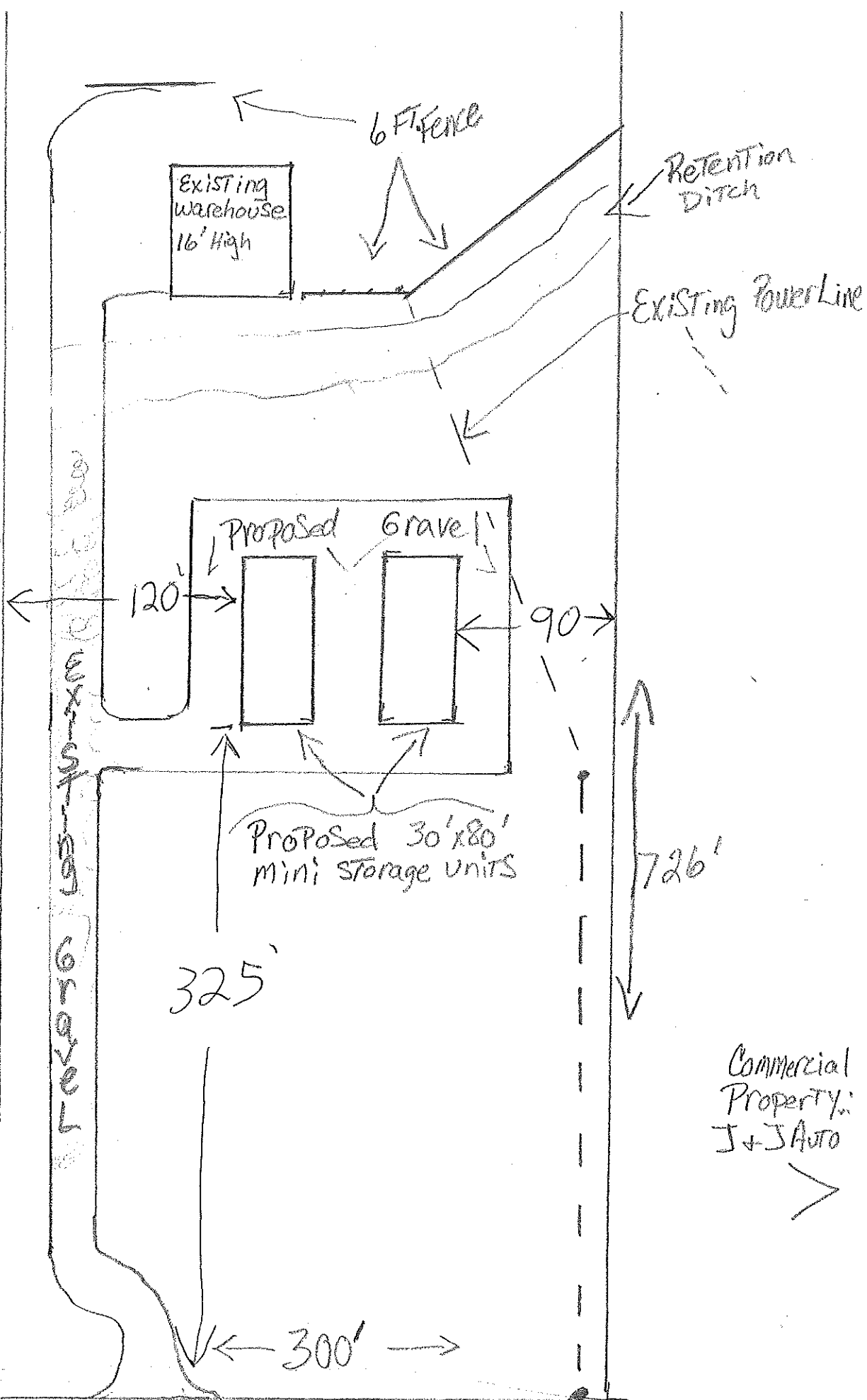

Commercial  
Property:  
J+J Auto

Weidman Rd  
EAST ← WEST →

Location Sketch on Back →

Woodruff Rd

Johnson Rd

Weidman Rd



Littlefield Rd

LESS 1000 AC.

PART OF THE NORTHEAST QUARTER OF SECTION 19, TOWNSHIP FIFTEEN NORTH, RANGE FIVE WEST, NOTTAWA TOWNSHIP, ISABELLA COUNTY, MICHIGAN, MORE PARTICULARLY DESCRIBED AS BEGINNING AT A POINT ON THE NORTH LINE OF SAID SECTION 19 WHICH IS NORTH 87°-13'-12" EAST, ALONG SAID NORTH SECTION LINE, 860.00 FEET FROM THE NORTH ¼ CORNER OF SAID SECTION 19, THENCE CONTINUING NORTH 87°-13'-12" EAST, ALONG SAID NORTH SECTION LINE, 300.00 FEET; THENCE SOUTH 00°-47'-00" EAST, PARALLEL WITH THE NORTH AND SOUTH ONE-QUARTER LINE OF SAID SECTION 19, 726.00 FEET; THENCE SOUTH 87°-13'-12" WEST, PARALLEL WITH SAID NORTH SECTION LINE, 300.00 FEET; THENCE NORTH 00°-47'-00" WEST, PARALLEL WITH SAID NORTH AND SOUTH ONE-QUARTER LINE, 726.00 FEET TO THE POINT OF BEGINNING CONTAINING 5.0 ACRES MORE OR LESS.

---

The public is invited to