



**ISABELLA COUNTY  
APPLICATION FOR HOUSE NUMBER/  
ADDRESS VERIFICATION**

200 N. Main Street  
Mt. Pleasant, MI 48858  
(989) 317-4061

\*\*\*OFFICE USE ONLY\*\*\*

Permit No.: \_\_\_\_\_  
Date: \_\_\_\_\_  
Check No.: \_\_\_\_\_  
Receipt No.: \_\_\_\_\_

OWNERS NAME \_\_\_\_\_ PROPERTY TAX ID # \_\_\_\_\_  
(Required)  
OWNERS EMAIL ADDRESS \_\_\_\_\_  
IS THIS A NEW SPLIT? ☐ YES \* ☐ NO \*If yes, a copy of the split record showing the correct legal description  
and property tax ID# assigned by the assessor must be attached.  
ROAD OR STREET YOU NEED ADDRESS ON \_\_\_\_\_ CITY \_\_\_\_\_  
OWNERS PRESENT MAILING ADDRESS \_\_\_\_\_  
CITY \_\_\_\_\_ STATE \_\_\_\_\_ ZIP \_\_\_\_\_  
OWNERS PHONE NUMBER \_\_\_\_\_

**WHAT SIDE OF THE ROAD** ☐ NORTH ☐ SOUTH ☐ EAST ☐ WEST

BETWEEN WHAT TWO CROSSROADS \_\_\_\_\_

DIRECTIONS: \_\_\_\_\_  
\_\_\_\_\_

WHAT BEST DESCRIBES YOUR LOCATION? (Check One)

☐ NEW CONSTRUCTION ☐ EXISTING HOME ☐ EMPTY LOT

☐ OTHER EXPLAIN: \_\_\_\_\_

NUMBER REQUESTED BY: \_\_\_\_\_  
(Signature of Applicant)

**GREEN E911 SIGN**

☐ I acknowledge that Isabella County has offered me an E911 address sign and I have elected "**NOT**" to accept it.

☐ I acknowledge that I "**would like**" the E911 sign offered to me by Isabella County.

\*\*\*Complete at Time of Sign Pick Up\*\*\*

SIGNATURE \_\_\_\_\_

I acknowledge that I have received an E911 sign from Isabella County on \_\_\_\_\_  
Date

**PLEASE COMPLETE THE ATTACHED PLOT PLAN**

\*\*\* FOR OFFICE USE ONLY \*\*\*

ADDRESS ASSIGNED \_\_\_\_\_ DATE # ASSIGNED \_\_\_\_\_  
INSPECTOR \_\_\_\_\_ DATE \_\_\_\_\_

**PLOT PLAN**

**Please show the following on the plot plan below or the application may not be accepted.**

- 1. North arrow
- 2. Proposed driveway/existing driveway
- 3. Distance from side lot lines to center of driveway

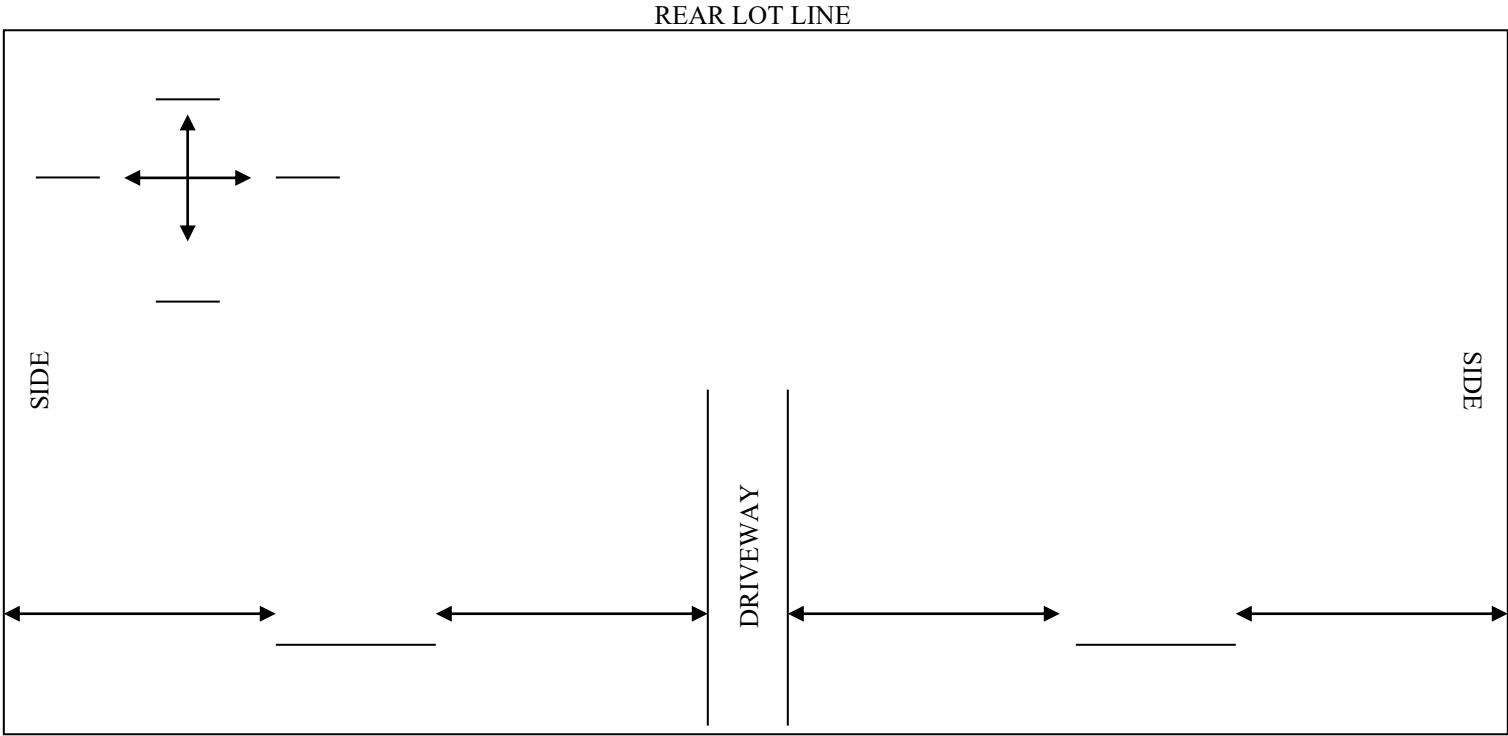

FRONT LOT LINE & STREET RIGHT OF WAY LINE

STREET NAME: \_\_\_\_\_