

Minde B. Lux, County Clerk
Leann Ellis, Chief Deputy
Kim Fussman, Deputy Clerk
Jamie Sawade, Deputy Clerk
Amber Smith, Court Clerk

Ext. 1205
Ext. 1260
Ext. 1259
Ext. 1261
Ext. 1461



200 North Main Street
Mt. Pleasant, MI 48858
Phone (989) 772-0911 Ext. 1205
Fax (989) 772-6347

www.isbellacounty.org
clerk@isbellacounty.org

February 25, 2026

Isabella County Planning Commission
510 West Pickard
Mt Pleasant, MI 48858

**RE: MICHAEL AND JAMIE KLUMPP HOLDINGS LLC FARMLAND
AGREEMENT APPLICATION**

Attached please find copies of the **MICHAEL AND JAMIE KLUMPP HOLDINGS LLC FARMLAND AGREEMENT APPLICATION (5)**. Please present these applications to the Planning Commission Board for review. The Board has 30 days to review and comment on the application and provide feedback. After 30 days the application will be presented to the Isabella County Board of Commissioners for their approval/rejection.

If you have any further questions, please do not hesitate to contact me at 317-4070, ext. 1205.

Sincerely,

A handwritten signature in black ink that reads "Minde B. Lux". The signature is fluid and cursive, with the first letters of the first and last names being capitalized and prominent.

Minde' B. Lux
Isabella County Clerk

RECEIVED

FEB 27 2026

INSPECTION DEPT.

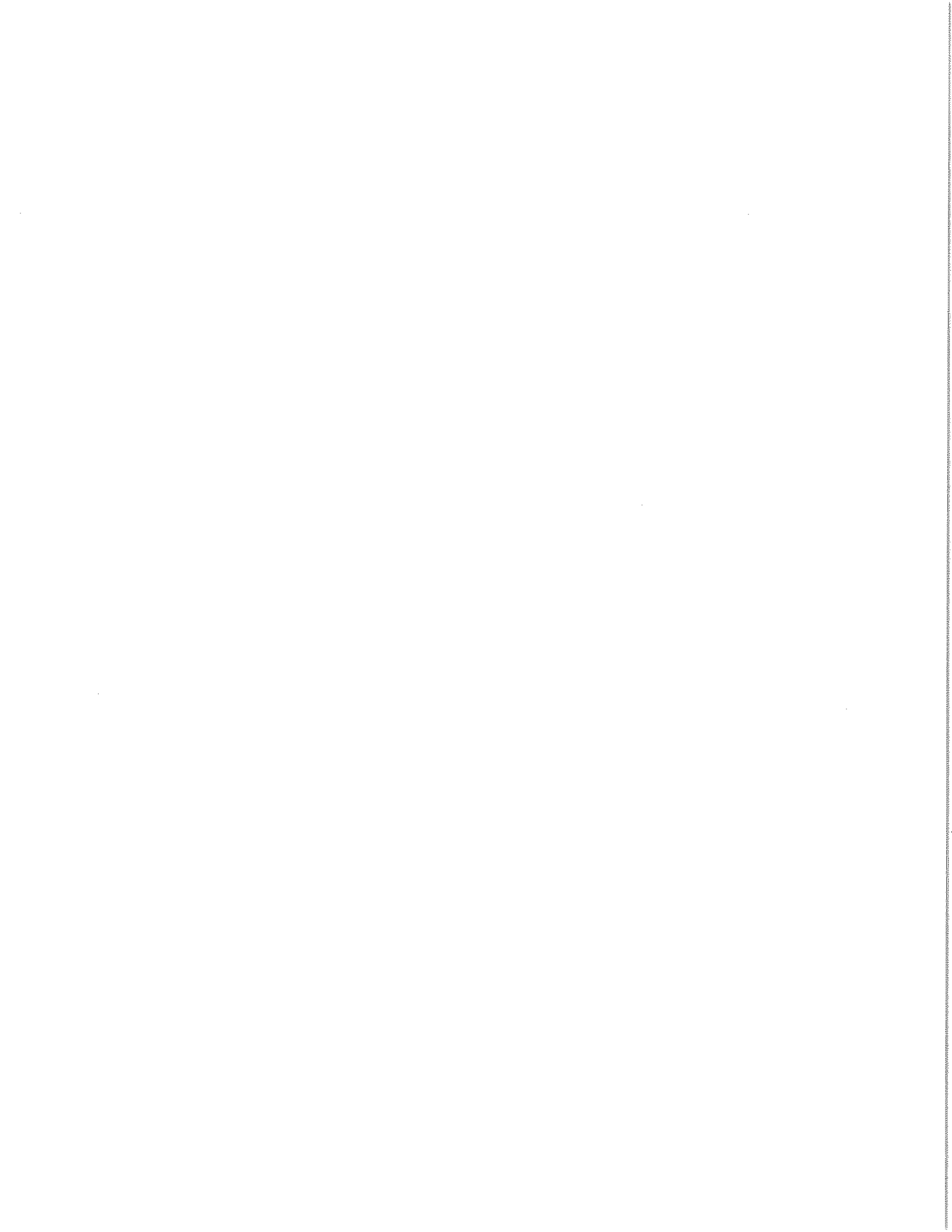



Farmland and Open Space Preservation Program

Application for Farmland Development Rights Agreement

Contact and Legal Information

Please print or type responses. Attach additional sheets as needed. Refer to the Eligibility and Instructions document before filling out this form.

ALL APPLICATIONS MUST BE APPROVED BY LOCAL GOVERNING BODY ON OR BEFORE NOVEMBER 1 TO BE EFFECTIVE FOR THE CURRENT TAX YEAR.

OFFICIAL USE ONLY	FILED
Local Governing Body	
Date received:	FEB 23 2026
Application #:	COUNTY CLERK ISABELLA COUNTY MT. PLEASANT MICH.

I. Personal Information

1. Name(s) of applicant

Klumpp	Michael		A
Last	First		Initial
(If more than two, see #18) Klumpp	Jaime		L
Last	First		Initial

2. Entity name:

Mike and Jaime Klumpp Holdings L.L.C.

3. Mailing address:

300 S University St.	Mt. Pleasant	MI	48858
Street	City	State	Zip Code

4. Phone number: (989) 621-3577

5. Alternative telephone number (cell, work, etc.): (989) 621-3579

6. Email address: mklumpp@mak56.com

II. Property Location (can be taken from the deed/land contract)

7. County: Isabella

8. Township, city, or village: Lincoln

9. Section #: 2 Town #: 13

Range #: 4 Parcel # (Tax ID): 10-002-30-003-04

III. Legal Information

10. Attach a clear copy of the recorded deed or land contract. Must include all pages and must include the legal description. (See #15, #16, and #17)

11. Date of purchase from your deed: 11/19/2025

NOTE: If land was transferred from yourself to your trust, a copy of the previous deed indicating whom you purchased it from is required.

CONTACT AND LEGAL INFORMATION CONTINUES ON PAGE 5

12. Attach a clear copy of the most recent tax assessment or tax bill with complete tax description of property.

13. Is there a tax lien against the land described above? Yes No

If "Yes," please explain circumstances:

14. Does the applicant own the mineral rights? Yes No Unknown

If owned by the applicant, are the mineral rights leased? Yes No

Indicate who owns or is leasing rights if other than the applicant:

MAK Oil & Gas

Name the type(s) of mineral(s) involved: Oil, gas, and other minerals

15. Is land cited in the application subject to a lease agreement (other than for mineral rights) permitting use for something other than agricultural purposes? Yes No

If "Yes," indicate to whom, for what purpose, and the number of acres involved:

16. Is land cited in the application subject to any other encumbrances (such as easements) that would prohibit agricultural use of the property, or impact the applicant's eligibility for the farmland tax credit? Yes No Unknown

If "Yes," indicate the type of encumbrance and grantee:

17. Is land being purchased under land contract? Yes No

If "Yes," a complete copy of the recorded land contract is required and must include the name and address of both the vendor (seller) and vendee (buyer).

If the property is under land contract, the vendor (seller) must agree to allow the land cited in the application to be enrolled in the program. Please have the land contract seller sign below (all sellers must sign).

Land Contract Vendor(s): I, the undersigned, understand and agree to permit the land cited in this application to be enrolled in the Farmland and Open Space Preservation Program.

Printed Name of Land Contract Vendor (Seller)

Signature of Land Contract Vendor (Seller)

Date

CONTACT AND LEGAL INFORMATION CONTINUES ON PAGE 6

18. Please check the appropriate selection(s) below. A copy of the executed document supporting your choice must be provided (trust, agreement, articles of incorporation, etc.).

- 2 or more persons have a joint or common interest in the land
- Corporation Limited Liability Company Partnership
- Estate Trust Association

If applicable, list the following: Individual Names if more than 2 Persons, President, Vice President, Secretary, Treasurer, Trustee(s), Member(s), Partner(s), or Estate Representative(s):

Name: _____ Title: _____

Name: _____ Title: _____

Name: _____ Title: _____

Name: _____ Title: _____

(Additional names may be attached on a separate sheet)

LAND ELIGIBILITY

IV. Land Eligibility Qualifications: Check one and fill out the correct section(s).

This application is for

- 40 acres or more and 51% agriculture use → Complete only Section 19 (a-g).
- 5 acres or more but less than 40 acres and 51% agriculture use and income requirement → Complete only Sections 19 and 20.
- A specialty farm of 15 acres or more → Complete only Sections 19 and 21.

19. a. Type of agricultural enterprise (e.g. livestock, cash crops, fruit, etc.):

Cash crops

b. Total number of acres on this farm: 26.32

c. Total number of acres to be enrolled (if different than above): _____

d. Acreage in cultivation: 22.52

e. Acreage in cleared, fenced, improved pasture, or harvested grassland: 0

f. All other acres (swamp, woods, etc.): 3.8

g. Indicate any structures on the property (If more than one structure, indicate the number of structures):

Total: 0

NOTE: Rental houses and other non-agricultural structures are not considered a permitted use and will require a survey to exclude these uses from the application.

Description of structures (include items such as residence, barn, shed, silo, wind turbines, cell towers, etc.): _____

20. To qualify as agricultural land of 5 acres or more but less than 40 acres, the land must produce a gross annual income from agriculture of \$200.00 per year or more per acre of cleared and tillable land.

» Supporting documentation is necessary to validate the income requirements.

» Landowner signature on the application is required to certify the income information provided.

» A signed statement by a licensed professional (such as an attorney or accountant) may also be provided.

21. To qualify as a specialty farm, the land must be 15 acres or more in size, and produce a gross annual income from an agricultural use of \$2,000 or more. If applying as a specialty farm, provide a signed affidavit attesting to the annual income earned during 2 of the prior 3 years immediately preceding the application. A signed affidavit by a licensed professional is preferred (such as an attorney or accountant). Include supporting documentation.

NOTE: A specialty farm designation by MDARD may require an on-site visit by an MDARD staff person.

22. Number of years requested to enroll in a Farmland Agreement (minimum 10 years, maximum 90 years): 10

LANDOWNER SIGNATURE REQUIRED ON PAGE 8

Landowner Signature

V. Signature(s)

- 23. The undersigned certifies the information contained in this application is accurate and true, and identifies the owner of record, legal description of property, and all encumbrances affecting the title of the land.
- 24. The undersigned certifies that there are no additional encumbrances that would impact the agreement or eligibility for the farmland tax credit including:
 - a. Other conservation easements that would prevent agricultural use on the property.
 - b. Other easements granted to non-MDARD entities that could impact farmland tax credit eligibility.

Michael Klumpp

Printed Name of Applicant

[Handwritten Signature]

Signature of Applicant (Corporate Name, If Applicable)

Jaime Klumpp

Printed Name of Co-owner, If Applicable

[Handwritten Signature]

Signature of Co-owner, If Applicable (Signature of Corporate Officer)

member

Title

2-10-26

Date

member

Title

2-10-26

Date

ALL APPLICATIONS MUST BE APPROVED BY LOCAL GOVERNING BODY ON OR BEFORE NOVEMBER 1 IN ORDER TO BE EFFECTIVE FOR THE CURRENT TAX YEAR.

RESERVED FOR LOCAL GOVERNMENT USE: COMPLETED BY CLERK

I. Application Processing

Date application received: 2-23-2026 (Note: Local governing body has 45 days to take action)

Date action taken by local governing body jurisdiction: _____

County Township City Village

Included documentation: Resolution Meeting Minutes

This application is Approved Rejected

*Clerk must complete verification on the next page.

Date of approval or rejection by local governing body: _____
(If rejected, please attach statement from local governing body indicating reason(s) for rejection)

Property appraisal: \$ _____

Assessor certifies this is the current fair market value of the property.

Parcel # (Tax ID): _____

Clerk's name: Mindé B. Lux

Clerk's phone: (989) 317-4070 Clerk's email: mlux@isabellacounty.org

Mindé B. Lux Mindé B. Lux _____
Printed Name of Clerk Signature of Clerk Date

Assessor's name: _____

Assessor's phone: (____) ____-____ Assessor's email: _____

Printed Name of Assessor Signature of Assessor Date

LOCAL GOVERNING BODY VERIFICATION IS FOUND ON PAGE 10

II. Verification

Please verify the following:

- Upon filing an application, clerk issues receipt to the landowner indicating date received.
- Clerk notifies reviewing agencies by forwarding a copy of the application and attachments.
- If rejected, applicant is notified in writing within 10 days stating reason for rejection and the original application, attachments, etc. are returned to the applicant. Applicant then has 30 days to appeal to MDARD.
- If approved, applicant is notified within 10 days of the vote taken. Original application, board resolution or meeting minutes, and other supporting documentation (owner, size, use, and income documents if applicable), or emails to reviewing agencies for review/comment are sent to address at the bottom of the page.

PLEASE DO NOT SEND MULTIPLE COPIES OF APPLICATIONS AND/OR SEND ADDITIONAL ATTACHMENTS IN SEPARATE MAILINGS WITHOUT FIRST CONTACTING THE FARMLAND PRESERVATION OFFICE.

**Please verify the following regarding
Reviewing Agencies**

(The application must be sent to all reviewing agencies below for comment. Copies of the emails or letters to each reviewing agency should be included with the application package provided to MDARD.)

COPY SENT TO:

- County or Regional Planning Commission
- Conservation District
- Township (if county has zoning authority)

Before forwarding to State Agency

FINAL APPLICATION MUST INCLUDE:

- Copy of local governing body meeting minutes and/or resolution of approval
- Copy of deed or land contract (most recent showing current ownership)
- Copy of most recent tax bill (tax description and property assessment must be included)
- Map of farm
- Assessing office statement (fair market value)
- Copy of letters from review agencies (if available)
- Any other applicable documents (such as proof of income)

The local governing body can send completed applications to:

Mailing Address:
MDARD FARMLAND AND OPEN SPACE
PRESERVATION PROGRAM
P.O. BOX 30449
LANSING, MI 48909

Email: MDARD-PA116@Michigan.gov
Phone: [517-284-5663](tel:517-284-5663)
Fax: 517-335-3131



Document # 20250055513 QUIT C DEED
Isabella County, Michigan
Karen Jackson, Register of Deeds
Recorded: 11/19/2025 03:10 PM
OR LIBER 1914 PAGE 4382

QUIT CLAIM DEED-Statutory Form-MCL 565.152

KNOW ALL PERSONS BY THESE PRESENTS: That Michael A. Klumpp, a married man,
whose address is: 1955 E. Walton Rd, Shepherd, MI 48883

Quit Claim(s) to Mike and Jaime Klumpp Holdings, L.L.C. , a Michigan limited liability company,
whose address is 300 S University St. Mt. Pleasant, MI 48858

the following described premises situated in the Township of Lincoln, County of Isabella and
State of Michigan, to-wit:

PART OF THE SW 1/4 OF THE SW 1/4 OF SECTION 2 T13N R4W LINCOLN TOWNSHIP,
ISABELLA COUNTY MICHIGAN. DESCRIBED AS FOLLOWS COMM AT THE SOUTHWEST
CORNER OF SAID SECTION THEN N 02D 48M 49S E ON THE WEST LINE OF SAID
SECTION 315.55 FT TO THE POB TH CONT N02D 48M 49S E ON SAID WEST SECTION
LINE 650.23 FT TH N 89D 07M 35S E 785.74 FT TH N 02D 48M 49S E 278.42 FT TH N 89D
07M 35S E 638.45 FT TH S 01D 24M 07S W PARALLEL WITH SAID EAST LINE 1207.27 FT
TH N 89D 25M 59S W 648.41 FT N 11D 37M 31S E 96.78 FT TH N 00D 34M 01S E
PERPENDICULAR TO THE SOUTH LINE OF SAID SECTION 220.40 FT THN 89D 25M 59S W
802.20 FT BACK TO THE POB EXCEPT A PARCEL COMM AT THE SOUTHWEST CORNER
OF SAID SECTION, THEN N 02D-48M-49S E., ON THE WEST LINE OF SAID SECTION,
315.55 FT TO THE POB; THEN CONTINUING N 02D-48M-49S E 325.11 FT, PARALLEL WITH
THE WEST LINE OF SAID SECTION, THEN S 89D 50M 48S E 247.98 FT; THEN S
02D-50M-22S E 322 FT; THEN S 89D-25M-59S W 248 FT BACK TO THE POB AND EXCEPT
A PARCEL COMM AT THE SOUTHWEST CORNER OF SAID SECTION, THEN N
02D-48M-49S E., ON THE WEST LINE OF SAID SECTION, 640.66 FT TO THE POB; THEN
CONTINUING N 02D-48M-49S E 325.11 FT , PARALLEL WITH THE WEST LINE OF SAID
SECTION, THEN S 89D 07M 35S E 248 FT; THEN S 02D-50M-22S W 322 FT; THEN N
02D-48M-9S W 247.98 FT BACK TO THE POB 26.32 ACRES M/L . SPLIT FOR 2017 FROM
30-003-02 TO 30-003-04 & 30-003-05 & 30-003-06. AG EXEMPT TRANSFER FOR AFFID
L1627 P650 REGISTERED 03-22-13 FOR SALE WD L1627 P646 DATED 03-21-13 WITH 2014
CAPPED TV = 37794 & AV = 43300 (FOR 10-002-30-003-02). NEW PA 260 FORM FILED TO
REFLECT THE SPLITTING OF 10-002-30-003-02 TO 10-002-30-003-04 FOR 2017 L1731
P525 REGISTERED 05-18-16.

Commonly known as: E Walton Rd. 4000 mile

Tax I.D. Number: 10-002-30-003-04

for the full consideration of : \$1.00

Dated this 19 day of November 2025

Signed by:

[Signature]

Michael A. Klumpp, a married man

STATE OF MICHIGAN
COUNTY OF ISABELLA

The foregoing instrument was acknowledged before me this 19 day of November, 2025

By Michael A. Klumpp, a married man

[Signature]
(Notary Public Signature)

Bethany Myers
(Notary Public Printed Name)

State of Michigan, County of Ottawa, Acting in the county of Isabella, MI
(county) (state)

My commission expires: June 1, 2029



Instrument drafted by: Kaitlyn Klumpp
300 S University Mt. Pleasant MI 48858
After recording return to:
Mike and Jaime Klumpp Holdings LLC
300 S. University Mt. Pleasant MI 4885

2025 LINCOLN TOWNSHIP WINTER TAX BILL

10-002-30-003-04
Bill #

LINCOLN TOWNSHIP TREASURER
6554 S MISSION
MT PLEASANT MI 48858

KLUMPP MIKE JAMIE MAK ENTERPRISES
Property Address:
4000 E WALTON RD

Due Date	03/02/2026
Total Tax Due	\$1,204.04
Check Number	

RETURN TAX PAYMENT TO ABOVE ADDRESS

Make Check Payable To: LINCOLN TOWNSHIP TREASURER
Treasurer's PH: 989-430-0508

10-002-30-003-04
To: KLUMPP MIKE JAMIE MAK ENTERPRISES
1955 E WALTON RD
SHEPHERD, MI 48883

Amount Remitted: _____
Taxpayer Contact Ph #: _____

Please detach along dotted line -- Retain bottom for your records -- Submit top with payment and a contact PHONE NUMBER on stub and check.

****TREASURER IS NOT RESPONSIBLE FOR PAYMENTS MADE ON THE WRONG PROPERTY DESCRIPTION****

LINCOLN TOWNSHIP TREASURER	TAX DESCRIPTION	MILLAGE	AMOUNT
Treasurer's PH: 989-430-0508	CO-I-RIDE TRANS	0.86200	37.72
ISABELLA COUNTY, Michigan	CO-MED CARE FAC	1.00000	43.75
Parcel #: 10-002-30-003-04	CO-COM ON AGING	1.00000	43.75
Property Assessed To:	CO-PARKS & REC	0.35000	15.31
KLUMPP MIKE JAMIE MAK ENTERPRISES	10 TWP OPER	0.97390	42.61
1955 E WALTON RD	MT PL SCH OPER	18.00000	EXEMPT
SHEPHERD, MI 48883	MT PL DEBT 16	0.94000	41.13
Property Address:	MT PL DEBT 22	1.48000	64.76
4000 E WALTON RD	MT PL DEBT 24	1.32000	57.76
SHEPHERD MI 48883	GR/IS RESD OPER	0.26400	11.55
	GR/IS RESD SP ED	4.20000	183.78
	GR/IS RESD V ED	1.00000	43.75
	MID MICH COM COL	1.21210	53.04
	CHIP LIBRARY	1.75000	76.57
	D267 CHILDS CREE		331.01
	D550R SAUNDERS		125.40
	10 TWP FIRE SP		25.00
	Total Mills/Tax	34.35200	1,196.89
	Administration Fee		7.15
	TOTAL AMOUNT DUE		1,204.04
Acreage: 26.92			
Property Class: 102 AGRICULTURAL-VACAI			
School District: 37010 MT PLEASANT CITY SCI			
1 mill equals \$1.00 per \$1000 of Taxable Value.			

TAX BASE VALUES	Description of Lands or Personal Property: lengthy descriptions subject to space limitations
Taxable Value: 43,759	PART OF THE SW 1/4 OF THE SW 1/4 OF SECTION 2, T.13 N.-R.4 W., LINCOLN TOWNSHIP, ISABELLA COUNTY, MICHIGAN, DESCRIBED AS FOLLOWS: COMM AT THE SOUTHWEST CORNER OF SAID SECTION, THEN N.02-48'-49"E, ON THE WEST LINE OF SAID SECTION, 315.55 FT; TO THE POB. THEN CONT N.02-48'-49"E, ON SAID WEST SECTION LINE, 650.23 FT THEN N89'-07'-35"E 785.74 FT THEN N.02-48'-49"E, 278.42 FT, THEN N89'-07'-35"E 638.45 FT, THEN S.01'-24'-07"W, PARALLEL WITH SAID EAST LINE, 1207.27 FT, THEN N89'-25'-59"W 648.41 FT, N.11'-37'-31"E, 96.78 FT, THEN N.00'-34'-01"E, PERPENDICULAR TO THE SOUTH LINE OF SAID SECTION 220.40 FT, THEN N89'-25'-59"W 600.30 FT BACK TO THE POB. EXCEPT A PARCEL COMM AT THE SOUTHWEST CORNER OF SAID SECTION.
State Equalized Value: 67,400	
Assessed Value: 67,400	
Qualified Ag Exemption: 43,759	
% Declared Exempt: 100.0000	

OPERATING FISCAL YEARS	OPEN TO COLLECT TAXES AT LINCOLN TWP HALL OFFICE TUESDAY, DECEMBER 30, 2025 FROM 9 AM TO 5 PM. ALSO ON MONDAY, MARCH 2, 2026 FROM 9 AM TO 5 PM. TAKING COLLECTION BY MAIL IS PREFERRED. RECEIPT WILL BE RETURNED BY MAIL.
County: 10/01/2025 - 09/30/2026	
Twn/Cty/Village: 04/01/2025 - 03/31/2026	
School: 07/01/2025 - 06/30/2026	
State: 10/01/2025 - 09/30/2026	
Does NOT affect when the tax is due or its amount	

FOR QUESTIONS RELATING TO OWNER NAME, ADDRESS, DESCRIPTION AND/OR ASSESSMENT ISSUES, PLEASE CONTACT: THOMAS RAMON TWP SUPERVISOR/ASSESSOR PHONE: 989-944-3000 EMAIL: TOM.RAMON@HOTMAIL.COM	DUE AND PAYABLE 12/01/2025 THROUGH 03/02/2026 WITHOUT PENALTY. AS OF 03/03/2026 PAYABLE TO ISABELLA COUNTY TREASURER WITH A 4% ADMIN FEE AND 1% INTEREST PER MONTH UNTIL PAID. CONTACT ISABELLA COUNTY TREASURER FOR DELINQUENT PAYOFF AMOUNTS. POSTMARKS ARE NOT ACCEPTED BY THE TOWNSHIP OR COUNTY TREASURER.
--	---

Additional information about PRE's, ESCROW ACCOUNTS, TAX DEFERMENT and more on reverse side



Property Details: 10-002-30-003-04

Report

Prev Year Info	MBOR Assessed	Final SEV	Final Taxable
2024	\$64,800	\$64,800	\$42,444
2023	\$58,500	\$58,500	\$40,423

Land Information

Acreage:	26.32
Zoning:	
Town/Range/Sec	13N 04W 002

Tax Description

PART OF THE SW 1/4 OF THE SW 1/4 OF SECTION 2 T13 N R4W LINCOLN TOWNSHIP, ISABELLA COUNTY MICHIGAN, DESCRIBED AS FOLLOWS COMM AT THE SOUTHWEST CORNER OF SAID SECTION THEN N 02D 48M 49S E ON THE WEST LINE OF SAID SECTION 315.55 FT TO THE POB TH CONT N02D 48M 49S E ON SAID WEST SECTION LINE 650.23 FT TH N 89D 07M 35S E 785.74 FT TH N 02D 48M 49S E 278.42 FT TH N 89D 07M 35S E 638.45 FT TH S 01D 24M 07S W PARALLEL WITH SAID EAST LINE 1207.27 FT TH N 89D 25M 59S W 648.41 FT N 11D 37M 31S E 96.78 FT TH N 00D 34M 01S E PERPENDICULAR TO THE SOUTH LINE OF SAID SECTION 220.40 FT TH N 89D 25M 59S W 802.20 FT BACK TO THE POB EXCEPT A PARCEL COMM AT THE SOUTHWEST CORNER OF SAID SECTION, THEN N 02D-48M-49S E., ON THE WEST LINE OF SAID SECTION, 315.55 FT TO THE POB; THEN CONTINUING N 02D-48M-49S E 325.11 FT, PARALLEL WITH THE WEST LINE OF SAID SECTION, THEN S 89D 50M 48S E 247.98 FT; THEN S 02D-50M-22S E 322 FT, THEN S 89D-25M-59S W 248 FT BACK TO THE POB AND EXCEPT A PARCEL COMM AT THE SOUTHWEST CORNER OF SAID SECTION, THEN N 02D-48M-49S E., ON THE WEST LINE OF SAID SECTION, 640.66 FT TO THE POB; THEN CONTINUING N 02D-48M-49S E 325.11 FT, PARALLEL WITH THE WEST LINE OF SAID SECTION, THEN S 89D 07M 35S E 248 FT; THEN S 02D-50M-22S W 322 FT; THEN N 02D-48M-9S W 247.98 FT BACK TO THE POB 26.32 ACRES M/L SPLIT FOR 2017 FROM 30-003-02 TO 30-003-04 & 30-003-05 & 30-003-06 .AG EXEMPT TRANSFER FOR AFFID L1627 P650 REGISTERED 03-22-13 FOR SALE WD L1627 P646 DATED 03-21-13 WITH 2014 CAPPED TV = 37794 & AV = 43300 (FOR 10-002-30-003-02), NEW PA 250 FORM FILED TO REFLECT THE SPLITTING OF 10-002-30-003-02 TO 10-002-30-003-04 FOR 2017 L1731 P525 REGISTERED 05-18-16

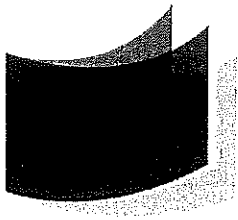

RPC
Roslund Prestage & Company
CERTIFIED PUBLIC ACCOUNTANTS

February 11, 2026

State of Michigan
PA 116 Division

Re: Michael Klumpp

To whom it may concern:

My name is Chad Payton and I am a CPA in Michigan, and one of our long-standing clients is Michael and Jaime Klumpp.

Please accept this letter as confirmation that the Klumpp's own a certain parcel of farmland that generates over \$200 per acre of gross income per year, and they are wanting to enroll this parcel in the PA 116 program.

We are hopeful that this letter will assist in the Klumpp family enrolling this parcel of land in the PA 116 program.

Please let us know if we can assist you further.

Sincerely,

Roslund, Prestage & Co, PC

Chad Payton, CPA
Roslund, Prestage & Company, PC
Certified Public Accountants

Please print or type responses. Attach additional sheets as needed. Refer to the Eligibility and Instructions document before filling out this form.

ALL APPLICATIONS MUST BE APPROVED BY LOCAL GOVERNING BODY ON OR BEFORE NOVEMBER 1 TO BE EFFECTIVE FOR THE CURRENT TAX YEAR.

OFFICIAL USE ONLY FILED
Local Governing Body _____
Date received: FEB 23 2026
Application #: _____
COUNTY CLERK
ISABELLA COUNTY
MT. PLEASANT MICH.

I. Personal Information

1. Name(s) of applicant

Klumpp	Michael		A
Last	First		Initial
(If more than two, see #18) Klumpp	Jaime		L
Last	First		Initial

2. Entity name:

Mike and Jaime Klumpp Holdings L.L.C.

3. Mailing address:

300 S University St.	Mt. Pleasant	MI	48858
Street	City	State	Zip Code

4. Phone number: (989) 621-3577

5. Alternative telephone number (cell, work, etc.): (989) 621-3579

6. Email address: mklumpp@mak56.com

II. Property Location (can be taken from the deed/land contract)

7. County: Isabella

8. Township, city, or village: Lincoln

9. Section #: 15 Town #: 13

Range #: 4 Parcel # (Tax ID): 10-015-10-001-008

III. Legal Information

10. Attach a clear copy of the recorded deed or land contract. Must include all pages and must include the legal description. (See #15, #16, and #17)

11. Date of purchase from your deed: 11/19/2025

NOTE: If land was transferred from yourself to your trust, a copy of the previous deed indicating whom you purchased it from is required.

12. Attach a clear copy of the most recent tax assessment or tax bill with complete tax description of property.

13. Is there a tax lien against the land described above? Yes No

If "Yes," please explain circumstances:

14. Does the applicant own the mineral rights? Yes No Unknown

If owned by the applicant, are the mineral rights leased? Yes No

Indicate who owns or is leasing rights if other than the applicant:

MAK Oil & Gas L.L.C.

Name the type(s) of mineral(s) involved: Oil, gas, and other minerals

15. Is land cited in the application subject to a lease agreement (other than for mineral rights) permitting use for something other than agricultural purposes? Yes No

If "Yes," indicate to whom, for what purpose, and the number of acres involved:

16. Is land cited in the application subject to any other encumbrances (such as easements) that would prohibit agricultural use of the property, or impact the applicant's eligibility for the farmland tax credit? Yes No Unknown

If "Yes," indicate the type of encumbrance and grantee:

17. Is land being purchased under land contract? Yes No

If "Yes," a complete copy of the recorded land contract is required and must include the name and address of both the vendor (seller) and vendee (buyer).

If the property is under land contract, the vendor (seller) must agree to allow the land cited in the application to be enrolled in the program. Please have the land contract seller sign below (all sellers must sign).

Land Contract Vendor(s): I, the undersigned, understand and agree to permit the land cited in this application to be enrolled in the Farmland and Open Space Preservation Program.

Printed Name of Land Contract Vendor (Seller)

Signature of Land Contract Vendor (Seller)

Date

Contact and Legal Information

18. Please check the appropriate selection(s) below. A copy of the executed document supporting your choice must be provided (trust, agreement, articles of incorporation, etc.).

- 2 or more persons have a joint or common interest in the land
- Corporation Limited Liability Company Partnership
- Estate Trust Association

If applicable, list the following: Individual Names if more than 2 Persons, President, Vice President, Secretary, Treasurer, Trustee(s), Member(s), Partner(s), or Estate Representative(s):

Name: _____ Title: _____

Name: _____ Title: _____

Name: _____ Title: _____

Name: _____ Title: _____

(Additional names may be attached on a separate sheet)

LAND ELIGIBILITY

IV. Land Eligibility Qualifications: Check one and fill out the correct section(s).

This application is for

- 40 acres or more and 51% agriculture use → Complete only Section 19 (a-g).
- 5 acres or more but less than 40 acres and 51% agriculture use and income requirement → Complete only Sections 19 and 20.
- A specialty farm of 15 acres or more → Complete only Sections 19 and 21.

19. a. Type of agricultural enterprise (e.g. livestock, cash crops, fruit, etc.):

Cash crops

b. Total number of acres on this farm: 69.36

c. Total number of acres to be enrolled (if different than above): _____

d. Acreage in cultivation: 60.86

e. Acreage in cleared, fenced, improved pasture, or harvested grassland: 0

f. All other acres (swamp, woods, etc.): 8.5

g. Indicate any structures on the property (if more than one structure, indicate the number of structures):

Total: 0

NOTE: Rental houses and other non-agricultural structures are not considered a permitted use and will require a survey to exclude these uses from the application.

Description of structures (include items such as residence, barn, shed, silo, wind turbines, cell towers, etc.): _____

20. To qualify as agricultural land of 5 acres or more but less than 40 acres, the land must produce a gross annual income from agriculture of \$200.00 per year or more per acre of cleared and tillable land.

- » Supporting documentation is necessary to validate the income requirements.
- » Landowner signature on the application is required to certify the income information provided.
- » A signed statement by a licensed professional (such as an attorney or accountant) may also be provided.

21. To qualify as a specialty farm, the land must be 15 acres or more in size, and produce a gross annual income from an agricultural use of \$2,000 or more. If applying as a specialty farm, provide a signed affidavit attesting to the annual income earned during 2 of the prior 3 years immediately preceding the application. A signed affidavit by a licensed professional is preferred (such as an attorney or accountant). Include supporting documentation.

NOTE: A specialty farm designation by MDARD may require an on-site visit by an MDARD staff person.

22. Number of years requested to enroll in a Farmland Agreement (minimum 10 years, maximum 90 years): 10

LANDOWNER SIGNATURE REQUIRED ON PAGE 8

Landowner Signature

V. Signature(s)

- 23. The undersigned certifies the information contained in this application is accurate and true, and identifies the owner of record, legal description of property, and all encumbrances affecting the title of the land.
- 24. The undersigned certifies that there are no additional encumbrances that would impact the agreement or eligibility for the farmland tax credit including:
 - a. Other conservation easements that would prevent agricultural use on the property.
 - b. Other easements granted to non-MDARD entities that could impact farmland tax credit eligibility.

Michael Klumpp

Printed Name of Applicant

member

Title

[Signature]
Signature of Applicant (Corporate Name, If Applicable)

2-10-26
Date

Jaime Klumpp

Printed Name of Co-owner, If Applicable

member

Title

Jaime Klumpp
Signature of Co-owner, If Applicable (Signature of Corporate Officer)

2-10-26
Date

ALL APPLICATIONS MUST BE APPROVED BY LOCAL GOVERNING BODY ON OR BEFORE NOVEMBER 1 IN ORDER TO BE EFFECTIVE FOR THE CURRENT TAX YEAR.

Local Governing Body Requirements

RESERVED FOR LOCAL GOVERNMENT USE: COMPLETED BY CLERK

I. Application Processing

Date application received: 2-23-2026 (Note: Local governing body has 45 days to take action)

Date action taken by local governing body jurisdiction: _____

County Township City Village

Included documentation: Resolution Meeting Minutes

This application is Approved Rejected

*Clerk must complete verification on the next page.

Date of approval or rejection by local governing body: _____
(If rejected, please attach statement from local governing body indicating reason(s) for rejection)

Property appraisal: \$ _____

Assessor certifies this is the current fair market value of the property.

Parcel # (Tax ID): _____

Clerk's name: Mindé B. Lux
 Clerk's phone: (989) 317-4070 Clerk's email: mlux@isabellacounty.org
Mindé B. Lux Mindé B. Lux _____
 Printed Name of Clerk Signature of Clerk Date

Assessor's name: _____
 Assessor's phone: (____) ____-____ Assessor's email: _____

 Printed Name of Assessor Signature of Assessor Date

LOCAL GOVERNING BODY VERIFICATION IS FOUND ON PAGE 10

II. Verification

Please verify the following:

- Upon filing an application, clerk issues receipt to the landowner indicating date received.
- Clerk notifies reviewing agencies by forwarding a copy of the application and attachments.
- If rejected, applicant is notified in writing within 10 days stating reason for rejection and the original application, attachments, etc. are returned to the applicant. Applicant then has 30 days to appeal to MDARD.
- If approved, applicant is notified within 10 days of the vote taken. Original application, board resolution or meeting minutes, and other supporting documentation (owner, size, use, and income documents if applicable), or emails to reviewing agencies for review/comment are sent to address at the bottom of the page.

PLEASE DO NOT SEND MULTIPLE COPIES OF APPLICATIONS AND/OR SEND ADDITIONAL ATTACHMENTS IN SEPARATE MAILINGS WITHOUT FIRST CONTACTING THE FARMLAND PRESERVATION OFFICE.

Please verify the following regarding Reviewing Agencies

(The application must be sent to all reviewing agencies below for comment. Copies of the emails or letters to each reviewing agency should be included with the application package provided to MDARD.)

COPY SENT TO:

- County or Regional Planning Commission
- Conservation District
- Township (if county has zoning authority)

Before forwarding to State Agency

FINAL APPLICATION MUST INCLUDE:

- Copy of local governing body meeting minutes and/or resolution of approval
- Copy of deed or land contract (most recent showing current ownership)
- Copy of most recent tax bill (tax description and property assessment must be included)
- Map of farm
- Assessing office statement (fair market value)
- Copy of letters from review agencies (if available)
- Any other applicable documents (such as proof of income)

The local governing body can send completed applications to:

Mailing Address:
MDARD FARMLAND AND OPEN SPACE
PRESERVATION PROGRAM
P.O. BOX 30449
LANSING, MI 48909

Email: MDARD-PA116@Michigan.gov
Phone: [517-284-5663](tel:517-284-5663)
Fax: 517-335-3131

Document # 20250055511 QUIT C DEED
Isabella County, Michigan
Karen Jackson, Register of Deeds
Recorded: 11/19/2025 03:10 PM
OR LIBER 1914 PAGE 4378

QUIT CLAIM DEED-Statutory Form-MCL 565.152

KNOW ALL PERSONS BY THESE PRESENTS: That MAK Enterprises, LLC., a Michigan limited liability company, whose address is: 1955 E. Walton Rd, Shepherd, MI 48883

Quit Claim(s) to Mike and Jaime Klumpp Holdings, L.L.C. , a Michigan limited liability company, whose address is 300 S University St. Mt. Pleasant, MI 48858

the following described premises situated in the Township of Lincoln, County of Isabella and State of Michigan, to-wit:

PART OF THE E 1/2 OF NW 1/4 OF SEC 15 T13N R4W LINCOLN TOWNSHIP ISABELLA COUNTY MI DESCRIBED AS BEG AT THE NORTH 1/4 COR OF SAID SEC 15 TH N 89D 53M 36S W ALONG THE NORTH SEC LINE 30 FT TH S 00D 05M 19S E PARALLEL TO THE N/S 1/4 LINE 440 FT TH N 89D 53M 36S W PARALLEL TO SAID N SEC LINE 170 FT TH N 00D 05M 18S W PARALLEL TO SAID N/S SECTION LINE 440 FT TO SAID N/S SEC LINE TH N 89D 53M 36S W ALONG SAID N/S SEC LINE 69.29 FT TH S 00D 05M 18S E PARALLEL TO SAID N/S 1/4 LINE 208.71 FT TH N 89D 53M 36S W PARALLEL TO SAID NORTH SEC LINE 169.13 FT TH S 00D 05M 18S E PARALLEL TO SAID N/S 1/4 LINE 209.29 FT TH N 89D 53M 36S W PARALLEL TO SAID NORTH SEC LINE 888.43 FT TO THE W 1/8 LINE TH S 00D 06M 11S E ALONG SAID W 1/8 LINE 2222.52 FT TO THE E/W 1/4 LINE TH S 89D 53M 51S E ALONG SAID E/W 1/4 LINE 1326.27 FT TO SAID N/S 1/4 LINE TH N 00D 05M 18S ALONG SAID N/S 1/4 LINE 2640.42 FT BACK TO THE POB 69.36 ACRES M/L.SPLIT FOR 2017 FROM 10-001-04 TO 10-001-06 & 10-001-07.AG EXEMPT TRANSFER FOR AFFID L1742 P755 REGISTERED09-06-16 FOR SALE WD L1742 P748 DATED 09-01-16WITH 2017 CAPPED TV = 83212 & AV = 102400.RETIRE FOR 2018 10-001-06 SPLIT TO 10-001-08 & 10-001-09 ALSO 10-001-05 RETIRED FOR 2018 COMBINED TO 10-001-09

Commonly known as: Finch. E. Blanchard Rd. 3000 mi. Mt. Pleasant, MI 48858

Tax I.D.Number: 10-015-10-001-06

for the full consideration of : \$1.00

Dated this 19 day of November 2025

Signed by:

[Signature]

Michael A. Klumpp, a member of MAK Enterprises, LLC., a Michigan limited liability company

STATE OF MICHIGAN
COUNTY OF ISABELLA

The foregoing instrument was acknowledged before me this 19 day of November, 2025
By Michael A. Klumpp, a member of MAK Enterprises, LLC., a Michigan limited liability

[Signature]

(Notary Public Signature)

Bethany Myers

(Notary Public Printed Name)

State of Michigan, County of Ottawa, Acting in the county of Isabella, MI
(county) (state)

My commission expires: June 1, 2029

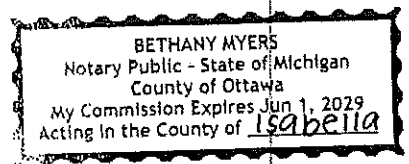

Instrument drafted by: Kaitlyn Klumpp
300 S University Mt. Pleasant MI 48858
After recording return to:
Mike and Jaime Klumpp Holdings LLC
300 S. University Mt. Pleasant MI 48858

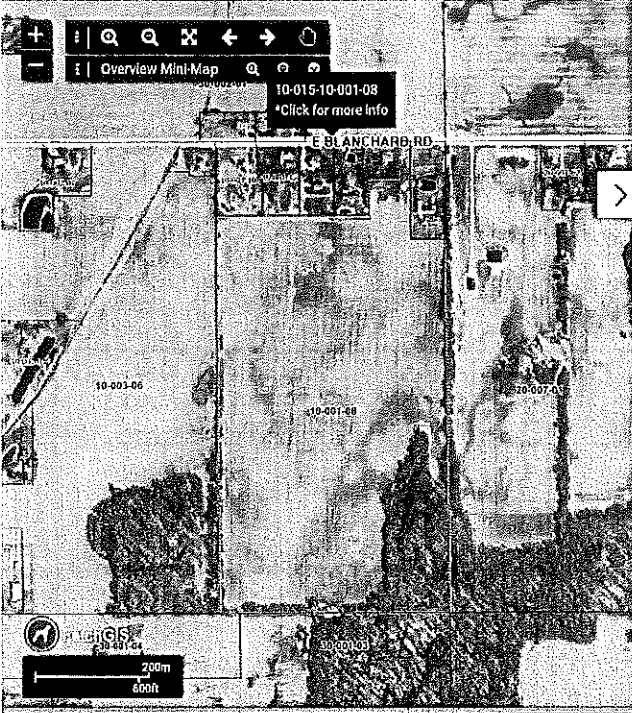

Property Details: 10-015-10-001-08

[Report](#)

Prev Year Info	MBOR Assessed	Final SEV	Final Taxable
2024	\$153,700	\$153,700	\$101,180
2023	\$141,300	\$141,300	\$96,362

Land Information

Acreage:	68.55
Zoning:	
Town/Range/Sec	13N 04W 015

Tax Description

PART OF THE EAST 1/2 OF THE NORTHWEST 1/4 OF SECTION 15, T13N R4W, LINCOLN TOWNSHIP, ISABELLA COUNTY, STATE OF MICHIGAN, DESCRIBED AS: BEGINNING AT THE NORTH 1/4 CORNER OF SAID SECTION 15, THEN S 00D-05M-19S E, PARALLEL TO THE N-S 1/4 LINE, 550 FT; THEN N 89D-53M-36S W PARALLEL TO N SECTION LINE, 200 FT; THEN N 00D-05M-18S W, PARALLEL TO SAID N-S SECTION LINE 550 FT TO SAID N-S SECTION LINE; THEN N 89D-53M-36S W, ALONG SAID N-S SECTION LINE 69.29 FT; THEN S 00D-05M-18S E, PARALLEL TO SAID N-S 1/4 LINE, 208.71 FT; THEN N 89D-53M-36S W, PARALLEL TO SAID NORTH SECTION LINE, 169.13 FT; THEN S 00D-05M-18S E, PARALLEL TO SAID N-S 1/4 LINE, 209.29 FT; THEN N 89D-53M-36S W, PARALLEL TO SAID NORTH SECTION LINE, 888.43 FT TO THE W 1/8 LINE; THEN S 00D-06M-11S E, ALONG SAID W 1/8 LINE, 2222.52 FT TO THE E-W 1/4 LINE, THEN S 89D-53M-51S E, ALONG SAID E-W 1/4 LINE, 1326.27 FT TO SAID N-S 1/4 LINE, THEN N 00D-05M-18S ALONG SAID N-S 1/4 LINE, 2090.52 FT BACK TO THE POB CONTAINING 68.55 ACRES M/L SPLIT FOR 2018 FROM 10-001-06 TO 10-001-08 & 10-001-09 ALSO 10-001-05 COMBINED FOR 2018 TO 10-001-09. AG EXEMPT TRANSFER FOR AFFID L1742 P755 REGISTERED 09-06-16 FOR SALE WD L1742 P748 DATED 09-01-16 WITH 2017 CAPPED TV = 83212 & AV = 102400 (FOR 10-015-10-001-06)

Sales Information

No Records Found

Tax History

Year, Season	Total Tax & Fees	Total Paid	Last Paid	Total Due *
2025 Winter	\$2,266.83	\$0.00		\$2,266.83

Please print or type responses. Attach additional sheets as needed. Refer to the Eligibility and Instructions document before filling out this form.

ALL APPLICATIONS MUST BE APPROVED BY LOCAL GOVERNING BODY ON OR BEFORE NOVEMBER 1 TO BE EFFECTIVE FOR THE CURRENT TAX YEAR.

OFFICIAL USE ONLY

Local Governing Body

Date received: _____

Application #: _____

FILED

FEB 23 2026

COUNTY CLERK
ISABELLA COUNTY
MT. PLEASANT MICH.

I. Personal Information

1. Name(s) of applicant

Klumpp Michael A

Last First Initial

(If more than two, see #18) Klumpp Jaime L

Last First Initial

2. Entity name:

Mike and Jaime Klumpp Holdings L.L.C.

3. Mailing address:

300 S University St. Mt. Pleasant MI 48858

Street City State Zip Code

4. Phone number: (989) 621-3577

5. Alternative telephone number (cell, work, etc.): (989) 621-3579

6. Email address: mklumpp@mak56.com

II. Property Location (can be taken from the deed/land contract)

7. County: Isabella

8. Township, city, or village: Lincoln

9. Section #: 34 Town #: 13

Range #: 4 Parcel # (Tax ID): 10-034-20-001-01

III. Legal Information

10. Attach a clear copy of the recorded deed or land contract. Must include all pages and must include the legal description. (See #15, #16, and #17)

11. Date of purchase from your deed: 11/19/2025

NOTE: If land was transferred from yourself to your trust, a copy of the previous deed indicating whom you purchased it from is required.

12. Attach a clear copy of the most recent tax assessment or tax bill with complete tax description of property.

13. Is there a tax lien against the land described above? Yes No

If "Yes," please explain circumstances:

14. Does the applicant own the mineral rights? Yes No Unknown

If owned by the applicant, are the mineral rights leased? Yes No

Indicate who owns or is leasing rights if other than the applicant:

MAK Oil & Gas

Name the type(s) of mineral(s) involved: Oil, gas, and other minerals

15. Is land cited in the application subject to a lease agreement (other than for mineral rights) permitting use for something other than agricultural purposes? Yes No

If "Yes," indicate to whom, for what purpose, and the number of acres involved:

16. Is land cited in the application subject to any other encumbrances (such as easements) that would prohibit agricultural use of the property, or impact the applicant's eligibility for the farmland tax credit? Yes No Unknown

If "Yes," indicate the type of encumbrance and grantee:

17. Is land being purchased under land contract? Yes No

If "Yes," a complete copy of the recorded land contract is required and must include the name and address of both the vendor (seller) and vendee (buyer).

If the property is under land contract, the vendor (seller) must agree to allow the land cited in the application to be enrolled in the program. Please have the land contract seller sign below (all sellers must sign).

Land Contract Vendor(s): I, the undersigned, understand and agree to permit the land cited in this application to be enrolled in the Farmland and Open Space Preservation Program.

Printed Name of Land Contract Vendor (Seller)

Signature of Land Contract Vendor (Seller)

Date

18. Please check the appropriate selection(s) below. A copy of the executed document supporting your choice must be provided (trust, agreement, articles of incorporation, etc.).

- 2 or more persons have a joint or common interest in the land
- Corporation Limited Liability Company Partnership
- Estate Trust Association

If applicable, list the following: Individual Names if more than 2 Persons, President, Vice President, Secretary, Treasurer, Trustee(s), Member(s), Partner(s), or Estate Representative(s):

Name: _____ Title: _____

Name: _____ Title: _____

Name: _____ Title: _____

Name: _____ Title: _____

(Additional names may be attached on a separate sheet)

LAND ELIGIBILITY

IV. Land Eligibility Qualifications: Check one and fill out the correct section(s).

This application is for

- 40 acres or more and 51% agriculture use → Complete only Section 19 (a-g).
- 5 acres or more but less than 40 acres and 51% agriculture use and income requirement → Complete only Sections 19 and 20.
- A specialty farm of 15 acres or more → Complete only Sections 19 and 21.

19. a. Type of agricultural enterprise (e.g. livestock, cash crops, fruit, etc.):

Cash crops _____

b. Total number of acres on this farm: 37.65

c. Total number of acres to be enrolled (if different than above): _____

d. Acreage in cultivation: 28.65

e. Acreage in cleared, fenced, improved pasture, or harvested grassland: 0

f. All other acres (swamp, woods, etc.): 9

g. Indicate any structures on the property (If more than one structure, indicate the number of structures):

Total: 0

NOTE: Rental houses and other non-agricultural structures are not considered a permitted use and will require a survey to exclude these uses from the application.

Description of structures (include items such as residence, barn, shed, silo, wind turbines, cell towers, etc.): _____

20. To qualify as agricultural land of 5 acres or more but less than 40 acres, the land must produce a gross annual income from agriculture of \$200.00 per year or more per acre of cleared and tillable land.

- » Supporting documentation is necessary to validate the income requirements.
- » Landowner signature on the application is required to certify the income information provided.
- » A signed statement by a licensed professional (such as an attorney or accountant) may also be provided.

21. To qualify as a specialty farm, the land must be 15 acres or more in size, and produce a gross annual income from an agricultural use of \$2,000 or more. If applying as a specialty farm, provide a signed affidavit attesting to the annual income earned during 2 of the prior 3 years immediately preceding the application. A signed affidavit by a licensed professional is preferred (such as an attorney or accountant). Include supporting documentation.

NOTE: A specialty farm designation by MDARD may require an on-site visit by an MDARD staff person.

22. Number of years requested to enroll in a Farmland Agreement (minimum 10 years, maximum 90 years): 10

LANDOWNER SIGNATURE REQUIRED ON PAGE 8

V. Signature(s)

23. The undersigned certifies the information contained in this application is accurate and true, and identifies the owner of record, legal description of property, and all encumbrances affecting the title of the land.
24. The undersigned certifies that there are no additional encumbrances that would impact the agreement or eligibility for the farmland tax credit including:
- a. Other conservation easements that would prevent agricultural use on the property.
 - b. Other easements granted to non-MDARD entities that could impact farmland tax credit eligibility.

Michael Klumpp

Printed Name of Applicant

Member

Title

[Signature]

Signature of Applicant (Corporate Name, If Applicable)

2-10-26

Date

Jaime Klumpp

Printed Name of Co-owner, If Applicable

member

Title

[Signature]

Signature of Co-owner, If Applicable (Signature of Corporate Officer)

2.10.26

Date

ALL APPLICATIONS MUST BE APPROVED BY LOCAL GOVERNING BODY ON OR BEFORE NOVEMBER 1 IN ORDER TO BE EFFECTIVE FOR THE CURRENT TAX YEAR.

RESERVED FOR LOCAL GOVERNMENT USE: COMPLETED BY CLERK

I. Application Processing

Date application received: 2-23-2026 (Note: Local governing body has 45 days to take action)

Date action taken by local governing body jurisdiction: _____

County Township City Village

Included documentation: Resolution Meeting Minutes

This application is Approved Rejected

***Clerk must complete verification on the next page.**

Date of approval or rejection by local governing body: _____

(If rejected, please attach statement from local governing body indicating reason(s) for rejection)

Property appraisal: \$ _____

Assessor certifies this is the current fair market value of the property.

Parcel # (Tax ID): _____

Clerk's name: Mindé B. Lux

Clerk's phone: 989, 317-4070

Clerk's email: mlux@isabellacounty.org

Mindé B. Lux
Printed Name of Clerk

Mindé B. Lux
Signature of Clerk

Date

Assessor's name: _____

Assessor's phone: (____) ____-____ Assessor's email: _____

Printed Name of Assessor

Signature of Assessor

Date

LOCAL GOVERNING BODY VERIFICATION IS FOUND ON PAGE 10

II. Verification

Please verify the following:

- Upon filing an application, clerk issues receipt to the landowner indicating date received.
- Clerk notifies reviewing agencies by forwarding a copy of the application and attachments.
- If rejected, applicant is notified in writing within 10 days stating reason for rejection and the original application, attachments, etc. are returned to the applicant. Applicant then has 30 days to appeal to MDARD.
- If approved, applicant is notified within 10 days of the vote taken. Original application, board resolution or meeting minutes, and other supporting documentation (owner, size, use, and income documents if applicable), or emails to reviewing agencies for review/comment are sent to address at the bottom of the page.

PLEASE DO NOT SEND MULTIPLE COPIES OF APPLICATIONS AND/OR SEND ADDITIONAL ATTACHMENTS IN SEPARATE MAILINGS WITHOUT FIRST CONTACTING THE FARMLAND PRESERVATION OFFICE.

**Please verify the following regarding
Reviewing Agencies**

(The application must be sent to all reviewing agencies below for comment. Copies of the emails or letters to each reviewing agency should be included with the application package provided to MDARD.)

COPY SENT TO:

- County or Regional Planning Commission
- Conservation District
- Township (if county has zoning authority)

Before forwarding to State Agency

FINAL APPLICATION MUST INCLUDE:

- Copy of local governing body meeting minutes and/or resolution of approval
- Copy of deed or land contract (most recent showing current ownership)
- Copy of most recent tax bill (tax description and property assessment must be included)
- Map of farm
- Assessing office statement (fair market value)
- Copy of letters from review agencies (if available)
- Any other applicable documents (such as proof of income)

The local governing body can send completed applications to:

Mailing Address:
MDARD FARMLAND AND OPEN SPACE
PRESERVATION PROGRAM
P.O. BOX 30449
LANSING, MI 48909

Email: MDARD-PA116@Michigan.gov
Phone: [517-284-5663](tel:517-284-5663)
Fax: 517-335-3131



Document # 20250055515 QUIT C DEED
Isabella County, Michigan
Karen Jackson, Register of Deeds
Recorded: 11/19/2025 03:10 PM
OR LIBER 1914 PAGE 4386

QUIT CLAIM DEED-Statutory Form-MCL 565.152

KNOW ALL PERSONS BY THESE PRESENTS: That Michael and Jaime Klumpp, husband and wife,

whose address is: 1955 E. Walton Rd, Shepherd, MI 48883

Quit Claim(s) to Mike and Jaime Klumpp Holdings, L.L.C. , a Michigan limited liability company,

whose address is 300 S University St. Mt. Pleasant, MI 48858

the following described premises situated in the Township of Lincoln, County of Isabella and State of Michigan, to-wit:

A PARCEL OF LAND BEING PART OF NE 1/4 OF NE 1/4 SEC 34 T13N R4W DESCRIBED AS COM AT THE NE COR OF SEC 34 TH S 1321.74 FT TH W 1330.67 FT TH N 1310.23 FT TH E 330 FT TH S 315 FT TH E 325 FT TH N 315 FT THE 678.39 FT BACK TO POB AND A PARCEL OF LAND COM AT THE SW COR OF NE 1/4 OF NE 1/4 TH W 3.5 RODS TH N 68 RODS THE 3.5 RODS TH S 68 RODS TO POB EXC A PARCEL OF LAND BEING PART OF NE 1/4 OF NE 1/4 SEC 34 DESCRIBED AS COM AT THE NE COR OF SEC 34 TH S 87D 55M 10S W ALG THE N SEC LINE 678.39 FT TO POB TH S 00D 59M 51S E PARALLEL WITH THE E 1/8 LINE 315 FT TH S 87D 55M 10S W PARALLEL WITH THE N SEC LINE 325 FT TH N 00D 59M 51S W PARALLEL WITH THE E 1/8 LINE 315 FT TO THE N SEC LINE TH N 87D 55M 10S E ALG THE N SEC LINE 325 FT TO POB ALSO EXC THE W 20 RODS OF THE N 12 RODS THEREOF 37.65 A M/L . SPLIT FOR 2010 FROM 20-001-00 TO 20-001-01 & 20-001-02. AG EXEMPT TRANSFER FOR AFFID L1506 P406 REGISTERED 01-19-2010 FOR SALE WD L1506 P393 DATED 01-15-2010 WITH 2011 CAPPED TV = 50914 = 45772 AV = 45772

Commonly known as: 3 E. Coe Rd. Shepherd, MI, 48883

Tax I.D.Number: 10-034-20-001-01

for the full consideration of : \$1.00

Dated this 19 day of November 2025

Signed by:

[Signature]

Michael Klumpp, a married man

[Signature]

Jaime Klumpp, a married woman

STATE OF MICHIGAN
COUNTY OF ISABELLA

The foregoing instrument was acknowledged before me this 19 day of November, 2025.
By Michael and Jaime Klumpp, husband and wife,

[Signature]
(Notary Public Signature)

Bethany Myers
(Notary Public Printed Name)

State of Michigan, County of Ottawa, Acting in the county of Isabella, MI
(county) (state)

My commission expires: June 1, 2029



Instrument drafted by: Kaitlyn Klumpp
300 S University Mt. Pleasant MI 48858
After recording return to:
Mike and Jaime Klumpp Holdings LLC
300 S. University Mt. Pleasant MI 48858

2025 LINCOLN TOWNSHIP WINTER TAX BILL

10-034-20-001-01
Bill #

LINCOLN TOWNSHIP TREASURER
6554 S MISSION
MT PLEASANT MI 48858

KLUMPP MICHAEL & JAIME
Property Address:
3000 E COE RD

Due Date	03/02/2026
Total Tax Due	\$1,069.94
Check Number	

RETURN TAX PAYMENT TO ABOVE ADDRESS

10-034-20-001-01
To: KLUMPP MICHAEL & JAIME
7700 S WHITEVILLE RD
SHEPHERD, MI 48883

Make Check Payable To: LINCOLN TOWNSHIP TREASURER
Treasurer's PH: 989-430-0508

Amount Remitted: _____
Taxpayer Contact Ph #: _____

Please detach along dotted line -- Retain bottom for your records -- Submit top with payment and a contact PHONE NUMBER on stub and check.
****TREASURER IS NOT RESPONSIBLE FOR PAYMENTS MADE ON THE WRONG PROPERTY DESCRIPTION****

<p>LINCOLN TOWNSHIP TREASURER Treasurer's PH: 989-430-0508 ISABELLA COUNTY, Michigan Parcel #: 10-034-20-001-01 Property Assessed To: KLUMPP MICHAEL & JAIME 7700 S WHITEVILLE RD SHEPHERD, MI 48883 Property Address: 3000 E COE RD SHEPHERD MI 48883 Acreage: 37.65 Property Class: 102 AGRICULTURAL-VACAI School District: 37060 SHEPHERD PUBLIC SCI</p>	<table style="width: 100%; border-collapse: collapse;"> <thead> <tr> <th style="text-align: left;">TAX DESCRIPTION</th> <th style="text-align: right;">MILLAGE</th> <th style="text-align: right;">AMOUNT</th> </tr> </thead> <tbody> <tr><td>CO-I-RIDE TRANS</td><td style="text-align: right;">0.86200</td><td style="text-align: right;">53.56</td></tr> <tr><td>CO-MED CARE FAC</td><td style="text-align: right;">1.00000</td><td style="text-align: right;">62.14</td></tr> <tr><td>CO-COM ON AGING</td><td style="text-align: right;">1.00000</td><td style="text-align: right;">62.14</td></tr> <tr><td>CO-PARKS & REC</td><td style="text-align: right;">0.35000</td><td style="text-align: right;">21.74</td></tr> <tr><td>10 TWP OPER</td><td style="text-align: right;">0.97390</td><td style="text-align: right;">60.51</td></tr> <tr><td>SHEPHERD SCH OP</td><td style="text-align: right;">18.00000</td><td style="text-align: right;">EXEMPT</td></tr> <tr><td>SHEP DEBT A08/17</td><td style="text-align: right;">7.00000</td><td style="text-align: right;">434.98</td></tr> <tr><td>GR/IS RESD OPER</td><td style="text-align: right;">0.26400</td><td style="text-align: right;">16.40</td></tr> <tr><td>GR/IS RESD SP ED</td><td style="text-align: right;">4.20000</td><td style="text-align: right;">260.99</td></tr> <tr><td>GR/IS RESD V ED</td><td style="text-align: right;">1.00000</td><td style="text-align: right;">62.14</td></tr> <tr><td>10 TWP FIRE SP</td><td></td><td style="text-align: right;">25.00</td></tr> <tr><td colspan="2" style="text-align: right;">Total Mills/Tax</td><td style="text-align: right;">34.64990</td></tr> <tr><td colspan="2" style="text-align: right;">Administration Fee</td><td style="text-align: right;">10.34</td></tr> <tr><td colspan="2" style="text-align: right;">TOTAL AMOUNT DUE</td><td style="text-align: right;">1,069.94</td></tr> </tbody> </table> <p style="text-align: center;">1 mill equals \$1.00 per \$1000 of Taxable Value.</p>	TAX DESCRIPTION	MILLAGE	AMOUNT	CO-I-RIDE TRANS	0.86200	53.56	CO-MED CARE FAC	1.00000	62.14	CO-COM ON AGING	1.00000	62.14	CO-PARKS & REC	0.35000	21.74	10 TWP OPER	0.97390	60.51	SHEPHERD SCH OP	18.00000	EXEMPT	SHEP DEBT A08/17	7.00000	434.98	GR/IS RESD OPER	0.26400	16.40	GR/IS RESD SP ED	4.20000	260.99	GR/IS RESD V ED	1.00000	62.14	10 TWP FIRE SP		25.00	Total Mills/Tax		34.64990	Administration Fee		10.34	TOTAL AMOUNT DUE		1,069.94
TAX DESCRIPTION	MILLAGE	AMOUNT																																												
CO-I-RIDE TRANS	0.86200	53.56																																												
CO-MED CARE FAC	1.00000	62.14																																												
CO-COM ON AGING	1.00000	62.14																																												
CO-PARKS & REC	0.35000	21.74																																												
10 TWP OPER	0.97390	60.51																																												
SHEPHERD SCH OP	18.00000	EXEMPT																																												
SHEP DEBT A08/17	7.00000	434.98																																												
GR/IS RESD OPER	0.26400	16.40																																												
GR/IS RESD SP ED	4.20000	260.99																																												
GR/IS RESD V ED	1.00000	62.14																																												
10 TWP FIRE SP		25.00																																												
Total Mills/Tax		34.64990																																												
Administration Fee		10.34																																												
TOTAL AMOUNT DUE		1,069.94																																												
<p style="text-align: center;">TAX BASE VALUES</p> <table style="width: 100%; border-collapse: collapse;"> <tr><td>Taxable Value:</td><td style="text-align: right;">62,141</td></tr> <tr><td>State Equalized Value:</td><td style="text-align: right;">91,000</td></tr> <tr><td>Assessed Value:</td><td style="text-align: right;">91,000</td></tr> <tr><td>Qualified Ag Exemption:</td><td style="text-align: right;">62,141</td></tr> <tr><td>% Declared Exempt:</td><td style="text-align: right;">100.0000</td></tr> </table>	Taxable Value:	62,141	State Equalized Value:	91,000	Assessed Value:	91,000	Qualified Ag Exemption:	62,141	% Declared Exempt:	100.0000	<p>Description of Lands or Personal Property: lengthy descriptions subject to space limitations A PARCEL OF LAND BEING PART OF THE NE 1/4 OF THE NE 1/4 OF SECTION 34, DESCRIBED AS COMMENCING AT THE NE CORNER OF SECTION 34, THEN S 1321.74 FT THEN W 1330.67 FT THEN N 1310.23 FT THEN E 330 FT THEN S 315 FT THEN E 325 FT THEN N 315 FT THEN E 678.39 FT BACK TO THE POB, AND A PARCEL OF LAND COMMENCING AT THE SW COR OF THE NE 1/4 OF THE NE 1/4 TH W 3.5 RODS, TH N 68 RODS, TH E 3.5 RODS, TH S 68 RODS TO POB. 37.65 ACRES M/L. SPLIT FOR 2010 TAX YEAR FROM 10-034-20-001-00 TO 20-001-01 AND 20-001-02. 5 + 2 SPLITS AVAILABLE EXC A PARCEL OF LAND BEING PART OF THE NE 1/4 OF THE NE 1/4 OF SECTION 34, DESCRIBED AS COMMENCING AT THE NE CORNER OF SECTION 34, THENCE S 870.66M 106 WEST ALG THE N</p>																																			
Taxable Value:	62,141																																													
State Equalized Value:	91,000																																													
Assessed Value:	91,000																																													
Qualified Ag Exemption:	62,141																																													
% Declared Exempt:	100.0000																																													
<p style="text-align: center;">OPERATING FISCAL YEARS</p> <table style="width: 100%; border-collapse: collapse;"> <tr><td>County:</td><td>10/01/2025</td><td>-</td><td>09/30/2026</td></tr> <tr><td>Twn/Cty/Village:</td><td>04/01/2025</td><td>-</td><td>03/31/2026</td></tr> <tr><td>School:</td><td>07/01/2025</td><td>-</td><td>06/30/2026</td></tr> <tr><td>State:</td><td>10/01/2025</td><td>-</td><td>09/30/2026</td></tr> </table> <p style="text-align: center;">Does NOT affect when the tax is due or its amount</p>	County:	10/01/2025	-	09/30/2026	Twn/Cty/Village:	04/01/2025	-	03/31/2026	School:	07/01/2025	-	06/30/2026	State:	10/01/2025	-	09/30/2026	<p>OPEN TO COLLECT TAXES AT LINCOLN TWP HALL OFFICE TUESDAY, DECEMBER 30, 2025 FROM 9 AM TO 5 PM. ALSO ON MONDAY, MARCH 2, 2026 FROM 9 AM TO 5 PM TAKING COLLECTION BY MAIL IS PREFERRED. RECEIPT WILL BE RETURNED BY MAIL.</p>																													
County:	10/01/2025	-	09/30/2026																																											
Twn/Cty/Village:	04/01/2025	-	03/31/2026																																											
School:	07/01/2025	-	06/30/2026																																											
State:	10/01/2025	-	09/30/2026																																											
<p>FOR QUESTIONS RELATING TO OWNER NAME, ADDRESS, DESCRIPTION AND/OR ASSESSMENT ISSUES, PLEASE CONTACT: THOMAS RAMON TWP SUPERVISOR/ASSESSOR PHONE: 989-944-3000 EMAIL: TOM.RAMON@HOTMAIL.COM</p>	<p>DUE AND PAYABLE 12/01/2025 THROUGH 03/02/2026 WITHOUT PENALTY. AS OF 03/03/2026 PAYABLE TO ISABELLA COUNTY TREASURER WITH A 4% ADMIN FEE AND 1% INTEREST PER MONTH UNTIL PAID. CONTACT ISABELLA COUNTY TREASURER FOR DELINQUENT PAYOFF AMOUNTS. POSTMARKS ARE NOT ACCEPTED BY THE TOWNSHIP OR COUNTY TREASURER.</p>																																													

Additional information about PRE's, ESCROW ACCOUNTS, TAX DEFERMENT and more on reverse side



Property Details: 10-034-20-001-01

Report

Prop. Class Name: AGRICULTURAL-VACANT State Equalized Value: \$91,000
 School Dist Code: 37060 Exemption Percent: 100
 School Dist Name: SHEPHERD PUBLIC SCHOOL DIST

Prev Year Info	MBOR Assessed	Final SEV	Final Taxable
2024	\$88,000	\$88,000	\$60,273
2023	\$79,600	\$79,600	\$57,403

Land Information

Acreage: 37.65
 Zoning:
 Town/Range/Sec 13N 04W 034

Tax Description

A PARCEL OF LAND BEING PART OF NE 1/4 OF NE 1/4 SEC 34 T13N R4W DESCRIBED AS COM AT THE NE COR OF SEC 34 TH S 1321.74 FT TH W 1330.67 FT TH N 1310.23 FT TH E 330 FT TH S 315 FT TH E 325 FT TH N 315 FT TH E 678.39 FT BACK TO POB AND A PARCEL OF LAND COM AT THE SW COR OF NE 1/4 OF NE 1/4 TH W 3.5 RODS TH N 68 RODS TH E 3.5 RODS TH S 68 RODS TO POB EXC A PARCEL OF LAND BEING PART OF NE 1/4 OF NE 1/4 SEC 34 DESCRIBED AS COM AT THE NE COR OF SEC 34 TH S 87D 55M 10S W ALG THE N SEC LINE 678.39 FT TO POB TH S 00D 59M 51S E PARALLEL WITH THE E 1/8 LINE 315 FT TH S 87D 55M 10S W PARALLEL WITH THE N SEC LINE 325 FT TH N 00D 59M 51S W PARALLEL WITH THE E 1/8 LINE 315 FT TO THE N SEC LINE TH N 87D 55M 10S E ALG THE N SEC LINE 325 FT TO POB ALSO EXC THE W 20 RODS OF THE N 12 RODS THEREOF 37.65 A M/L . SPLIT FOR 2010 FROM 20-001-00 TO 20-001-01 & 20-001-02 . AG EXEMPT TRANSFER FOR AFFID L1506 P406 REGISTERED 01-19-2010 FOR SALE WD L1506 P393 DATED 01-15-2010 WITH 2011 CAPPED TV = 50914 = 45772 AV = 45772

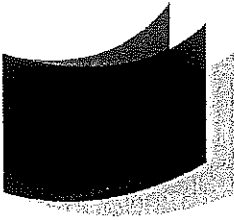

RPC
Roslund Prestage & Company
CERTIFIED PUBLIC ACCOUNTANTS

February 11, 2026

State of Michigan
PA 116 Division

Re: Michael Klumpp

To whom it may concern:

My name is Chad Payton and I am a CPA in Michigan, and one of our long-standing clients is Michael and Jaime Klumpp.

Please accept this letter as confirmation that the Klumpp's own a certain parcel of farmland that generates over \$200 per acre of gross income per year, and they are wanting to enroll this parcel in the PA 116 program.

We are hopeful that this letter will assist in the Klumpp family enrolling this parcel of land in the PA 116 program.

Please let us know if we can assist you further.

Sincerely,

Roslund, Prestage & Co, PC

Chad Payton, CPA
Roslund, Prestage & Company, PC
Certified Public Accountants



Farmland and Open Space Preservation Program

Application for Farmland Development Rights Agreement

Contact and Legal Information

Please print or type responses. Attach additional sheets as needed. Refer to the Eligibility and Instructions document before filling out this form.

ALL APPLICATIONS MUST BE APPROVED BY LOCAL GOVERNING BODY ON OR BEFORE NOVEMBER 1 TO BE EFFECTIVE FOR THE CURRENT TAX YEAR.

OFFICIAL USE ONLY

Local Governing Body _____

Date received: FILED

Application #: FEB 23 2026

COUNTY CLERK
ISABELLA COUNTY
MT. PLEASANT MICH.

I. Personal Information

1. Name(s) of applicant
Klumpp Michael A

Last First Initial

(If more than two, see #18) Klumpp Jaime L

Last First Initial

2. Entity name:
Mike and Jaime Klumpp Holdings L.L.C.

3. Mailing address:
300 S University St. Mt. Pleasant MI 48858

Street City State Zip Code

4. Phone number: (989) 621-3577

5. Alternative telephone number (cell, work, etc.): (989) 621-3579

6. Email address: mklumpp@mak56.com

II. Property Location (can be taken from the deed/land contract)

7. County: Isabella

8. Township, city, or village: Lincoln

9. Section #: 14 Town #: 13

Range #: 4 Parcel # (Tax ID): 10-014-10-002-05

III. Legal Information

10. Attach a clear copy of the recorded deed or land contract. Must include all pages and must include the legal description. (See #15, #16, and #17)

11. Date of purchase from your deed: 11/19/2025

NOTE: If land was transferred from yourself to your trust, a copy of the previous deed indicating whom you purchased it from is required.

CONTACT AND LEGAL INFORMATION CONTINUES ON PAGE 5

12. Attach a clear copy of the most recent tax assessment or tax bill with complete tax description of property.

13. Is there a tax lien against the land described above? Yes No

If "Yes," please explain circumstances:

14. Does the applicant own the mineral rights? Yes No Unknown

If owned by the applicant, are the mineral rights leased? Yes No

Indicate who owns or is leasing rights if other than the applicant:

MAK Oil & Gas L.L.C.

Name the type(s) of mineral(s) involved: Oil, gas, and other minerals

15. Is land cited in the application subject to a lease agreement (other than for mineral rights) permitting use for something other than agricultural purposes? Yes No

If "Yes," indicate to whom, for what purpose, and the number of acres involved:

16. Is land cited in the application subject to any other encumbrances (such as easements) that would prohibit agricultural use of the property, or impact the applicant's eligibility for the farmland tax credit? Yes No Unknown

If "Yes," indicate the type of encumbrance and grantee:

17. Is land being purchased under land contract? Yes No

If "Yes," a complete copy of the recorded land contract is required and must include the name and address of both the vendor (seller) and vendee (buyer).

If the property is under land contract, the vendor (seller) must agree to allow the land cited in the application to be enrolled in the program. Please have the land contract seller sign below (all sellers must sign).

Land Contract Vendor(s): I, the undersigned, understand and agree to permit the land cited in this application to be enrolled in the Farmland and Open Space Preservation Program.

Printed Name of Land Contract Vendor (Seller)

Signature of Land Contract Vendor (Seller)

Date

18. Please check the appropriate selection(s) below. A copy of the executed document supporting your choice must be provided (trust, agreement, articles of incorporation, etc.).

- 2 or more persons have a joint or common interest in the land
- Corporation Limited Liability Company Partnership
- Estate Trust Association

If applicable, list the following: Individual Names if more than 2 Persons, President, Vice President, Secretary, Treasurer, Trustee(s), Member(s), Partner(s), or Estate Representative(s):

Name: _____ Title: _____

Name: _____ Title: _____

Name: _____ Title: _____

Name: _____ Title: _____

(Additional names may be attached on a separate sheet)

LAND ELIGIBILITY

IV. Land Eligibility Qualifications: Check one and fill out the correct section(s).

This application is for

- 40 acres or more and 51% agriculture use → Complete only Section 19 (a-g).
- 5 acres or more but less than 40 acres and 51% agriculture use and income requirement → Complete only Sections 19 and 20.
- A specialty farm of 15 acres or more → Complete only Sections 19 and 21.

19. a. Type of agricultural enterprise (e.g. livestock, cash crops, fruit, etc.):

Cash crops

b. Total number of acres on this farm: 53.13

c. Total number of acres to be enrolled (if different than above): _____

d. Acreage in cultivation: 53

e. Acreage in cleared, fenced, improved pasture, or harvested grassland: 0

f. All other acres (swamp, woods, etc.): 0.13

g. Indicate any structures on the property (If more than one structure, indicate the number of structures):

Total: 0

NOTE: Rental houses and other non-agricultural structures are not considered a permitted use and will require a survey to exclude these uses from the application.

Description of structures (include items such as residence, barn, shed, silo, wind turbines, cell towers, etc.): _____

20. To qualify as agricultural land of 5 acres or more but less than 40 acres, the land must produce a gross annual income from agriculture of \$200.00 per year or more per acre of cleared and tillable land.

- » Supporting documentation is necessary to validate the income requirements.
- » Landowner signature on the application is required to certify the income information provided.
- » A signed statement by a licensed professional (such as an attorney or accountant) may also be provided.

21. To qualify as a specialty farm, the land must be 15 acres or more in size, and produce a gross annual income from an agricultural use of \$2,000 or more. If applying as a specialty farm, provide a signed affidavit attesting to the annual income earned during 2 of the prior 3 years immediately preceding the application. A signed affidavit by a licensed professional is preferred (such as an attorney or accountant). Include supporting documentation.

NOTE: A specialty farm designation by MDARD may require an on-site visit by an MDARD staff person.

22. Number of years requested to enroll in a Farmland Agreement (minimum 10 years, maximum 90 years): 10

V. Signature(s)

23. The undersigned certifies the information contained in this application is accurate and true, and identifies the owner of record, legal description of property, and all encumbrances affecting the title of the land.
24. The undersigned certifies that there are no additional encumbrances that would impact the agreement or eligibility for the farmland tax credit including:
- a. Other conservation easements that would prevent agricultural use on the property.
 - b. Other easements granted to non-MDARD entities that could impact farmland tax credit eligibility.

Michael Klumpp

Printed Name of Applicant

Title

Signature of Applicant (Corporate Name, If Applicable)

Date

Jaime Klumpp

Printed Name of Co-owner, If Applicable

Title

Signature of Co-owner, If Applicable (Signature of Corporate Officer)

Date

member

2-10-26

member

2-10-26

**ALL APPLICATIONS MUST BE APPROVED BY LOCAL GOVERNING BODY ON OR BEFORE
NOVEMBER 1 IN ORDER TO BE EFFECTIVE FOR THE CURRENT TAX YEAR.**

RESERVED FOR LOCAL GOVERNMENT USE: COMPLETED BY CLERK

I. Application Processing

Date application received: 2-23-2026 (Note: Local governing body has 45 days to take action)

Date action taken by local governing body jurisdiction: _____

County Township City Village

Included documentation: Resolution Meeting Minutes

This application is Approved Rejected

*Clerk must complete verification on the next page.

Date of approval or rejection by local governing body: _____
 (If rejected, please attach statement from local governing body indicating reason(s) for rejection)

Property appraisal: \$ _____

Assessor certifies this is the current fair market value of the property.

Parcel # (Tax ID): _____

Clerk's name: Mindé B. Lux
 Clerk's phone: 989 317 - 4070 Clerk's email: mlux@isabellacounty.org
Mindé B. Lux Mindé B. Lux _____
 Printed Name of Clerk Signature of Clerk Date

Assessor's name: _____
 Assessor's phone: (____) ____ - ____ Assessor's email: _____

 Printed Name of Assessor Signature of Assessor Date

LOCAL GOVERNING BODY VERIFICATION IS FOUND ON PAGE 10

II. Verification

Please verify the following:

- Upon filing an application, clerk issues receipt to the landowner indicating date received.
- Clerk notifies reviewing agencies by forwarding a copy of the application and attachments.
- If rejected, applicant is notified in writing within 10 days stating reason for rejection and the original application, attachments, etc. are returned to the applicant. Applicant then has 30 days to appeal to MDARD.
- If approved, applicant is notified within 10 days of the vote taken. Original application, board resolution or meeting minutes, and other supporting documentation (owner, size, use, and income documents if applicable), or emails to reviewing agencies for review/comment are sent to address at the bottom of the page.

PLEASE DO NOT SEND MULTIPLE COPIES OF APPLICATIONS AND/OR SEND ADDITIONAL ATTACHMENTS IN SEPARATE MAILINGS WITHOUT FIRST CONTACTING THE FARMLAND PRESERVATION OFFICE.

Please verify the following regarding Reviewing Agencies

(The application must be sent to all reviewing agencies below for comment. Copies of the emails or letters to each reviewing agency should be included with the application package provided to MDARD.)

COPY SENT TO:

- County or Regional Planning Commission
- Conservation District
- Township (if county has zoning authority)

Before forwarding to State Agency

FINAL APPLICATION MUST INCLUDE:

- Copy of local governing body meeting minutes and/or resolution of approval
- Copy of deed or land contract (most recent showing current ownership)
- Copy of most recent tax bill (tax description and property assessment must be included)
- Map of farm
- Assessing office statement (fair market value)
- Copy of letters from review agencies (if available)
- Any other applicable documents (such as proof of income)

The local governing body can send completed applications to:

Mailing Address:
MDARD FARMLAND AND OPEN SPACE
PRESERVATION PROGRAM
P.O. BOX 30449
LANSING, MI 48909

Email: MDARD-PA116@Michigan.gov

Phone: [517-284-5663](tel:517-284-5663)

Fax: 517-335-3131



Document # 20250055517 QUIT C DEED
Isabella County, Michigan
Karen Jackson, Register of Deeds
Recorded: 11/19/2025 03:10 PM
OR LIBER 1914 PAGE 4390

QUIT CLAIM DEED-Statutory Form-MCL 565.152

KNOW ALL PERSONS BY THESE PRESENTS: That MAK Enterprises, LLC., a Michigan limited liability company, whose address is: 1955 E. Walton Rd, Shepherd, MI 48883

Quit Claim(s) to Mike and Jaime Klumpp Holdings, L.L.C. , a Michigan limited liability company, whose address is 300 S University St. Mt. Pleasant, MI 48858

the following described premises situated in the Township of Lincoln, County of Isabella and State of Michigan, to-wit:

A PARCEL OF LAND BEING PART OF THE S 1/2 OF THE NW 1/4 OF SECTION 14, T13N-R4W, LINCOLN TOWNSHIP, ISABELLA COUNTY, MICHIGAN, DESCRIBED AS FOLLOWS: COMMENCING AT THE W 1/4 COR OF SAID SECTION; THEN N 00D-21M-40S W, ON AND ALONG THE WEST LINE OF SAID SECTION, 511.50 FT; THEN N 89D-38M-20S E, PERPINDICULAR TO SAID WEST SECTION LINE 245 FT, THEN N 62D-09M-45S E, 185 FT, THEN N 89D-58M-20S E 367.62 FT TO THE POINT OF CURVATURE OF A CURVE TO THE RIGHT HAVING A RADIUS OF 60 FT, THEN SOUTHEASTERLY ALONG THE ARC OF SAID CURVE, 94.25 FT TO THE POINT OF TANGENCY, SAID ARC BEING SUBTENDE BY A CHORD BEARING S 45D-01M-40S E, 84.85 FT TO SAID POINT TO TANGENCY, THEN S 01D-31M-35S W, 218.66 FT TO THE POINT OF CURVATURE OF A CURVE TO THE LEFT HAVING A RADIUS OF 35 FT; THEN SOUTHEASTERLY, ALONG THE ARC OF SAID CURVE, 56.39 FT TO THE POINT OF TANGENCY, SAID ARC BEING SUBTENDE BY A CHORD BEARING S 44D-34M-26S E, 50.49 FT TO THE SAID POINT OF TANGENCY; THEN N 89D-15M-59S E PARALLEL WITH EAST AND WEST 1/4 LINE OF SAID SECTION, 451.65 FT TO THE POINT OF CURVATURE OF A CURVE TO THE LEFT HAVING A RADIUS OF 60 FT; THEN NORTHEASTERLY, ALONG THE ARC OF SAID CURVE, 94.62 FT TO THE POINT OF TANGENCY, SAID ARC BEING SUBTENDE BY A CHORD BEARING N 44D-05M-24S E, 85.11 FT TO SAID POINT OF TANGENCY; THEN N 01D-05M-11S W 396.21 FT; THEN S 88D-54M-49S W 48.82 FT; THEN N 01D-05M-11S W 20 FT; THEN N 88D-54M-49S E 48.82 FT; THEN N 01D-05M-11S W 570.48 FT TO A POINT OF THE NORTH 1/8 LINE OF SAID SECTION; THEN N 89D-13M-18S E ON AND ALONG SAID NORTH 1/8 LINE, 1293.19 FT TO A POINT ON THE NORTH AND SOUTH 1/4 LINE OF SAID SECTION; THEN S 00D-18M-51S E ON AND ALONG SAID NORTH AND SOUTH 1/4 LINE, 1322.10 FT TO THE INTERIOR 1/4 CORNER OF SAID SECTION, BEING THE INTERSECTION OF THE NORTH AND SOUTH 1/4 LINE WITH THE EAST AND WEST 1/4 LINE; THEN S 89D-15M-59S

W ON AND ALONG THE EAST AND WEST ¼ LINE OF SAID SECTION, 2655.28 FT, BACK TO THE POB CONTAINING 53.13 ACRES OF LAND AND BEING SUBJECT TO HIGHWAY USE OF THE WESTERLY 33 FT THEREOF LYING ALONG AND ADJACENT TO THE WEST LINE OF SAID SECTION.COMBINATION/SPLIT FOR 2018 COMBINED 10-002-03 & 10-002-04 SPLIT TO 10-002-05 & 10-002-06.AG EXEMPT TRANSFER FOR AFFID L1765 P796 REGISTERED 04-12-17 FOR SALE WD L1765 P794 DATED 04-12-17WITH 2018 CAPPED TV = 47495 & AV = 78800

Commonly known as: S Mission Rd. Mt. Pleasant, MI 48858

Tax I.D.Number: 10-014-10-002-05

for the full consideration of : \$1.00

Dated this 19 day of November 2025

Signed by:

[Signature]
Michael A. Klumpp, a member of MAK Enterprises, LLC., a Michigan limited liability company

STATE OF MICHIGAN
COUNTY OF ISABELLA

The foregoing instrument was acknowledged before me this 19 day of November, 2025.
By Michael A. Klumpp, a member of MAK Enterprises, LLC., a Michigan limited liability

[Signature]
(Notary Public Signature)

Bethany Myers
(Notary Public Printed Name)

State of Michigan, County of Ottawa, Acting in the county of Isabella, MI
(county) (state)

My commission expires: June 1, 2029



Instrument drafted by: Kaitlyn Klumpp

300 S University Mt. Pleasant MI 48858

After recording return to:

Mike and Jaime Klumpp Holdings LLC

300 S. University Mt. Pleasant MI 48858

2025 LINCOLN TOWNSHIP WINTER TAX BILL

10-014-10-002-05
Bill #

LINCOLN TOWNSHIP TREASURER
6554 S MISSION
MT PLEASANT MI 48858

MAK ENTERPRISES
Property Address:
8000 S MISSION RD

Due Date	03/02/2026
Total Tax Due	\$1,782.53
Check Number	

RETURN TAX PAYMENT TO ABOVE ADDRESS

Make Check Payable To: **LINCOLN TOWNSHIP TREASURER**
Treasurer's PH: 989-430-0508

10-014-10-002-05
To: MAK ENTERPRISES
1955 E WALTON RD
SHEPHERD, MI 48883

Amount Remitted: _____
Taxpayer Contact Ph #: _____

Please detach along dotted line -- Retain bottom for your records -- Submit top with payment and a contact PHONE NUMBER on stub and check.

****TREASURER IS NOT RESPONSIBLE FOR PAYMENTS MADE ON THE WRONG PROPERTY DESCRIPTION****

<p>LINCOLN TOWNSHIP TREASURER Treasurer's PH: 989-430-0508 ISABELLA COUNTY, Michigan</p> <p>Parcel #: 10-014-10-002-05 Property Assessed To: MAK ENTERPRISES 1955 E WALTON RD SHEPHERD, MI 48883</p> <p>Property Address: 8000 S MISSION RD MT PLEASANT MI 48858</p> <p>Acreage: 53.13 Property Class: 102 AGRICULTURAL-VACA School District: 37060 SHEPHERD PUBLIC SCI</p> <p>1 mill equals \$1.00 per \$1000 of Taxable Value.</p>	<table style="width: 100%; border-collapse: collapse;"> <thead> <tr> <th style="text-align: left;">TAX DESCRIPTION</th> <th style="text-align: right;">MILLAGE</th> <th style="text-align: right;">AMOUNT</th> </tr> </thead> <tbody> <tr><td>CO-IRIDE TRANS</td><td style="text-align: right;">0.86200</td><td style="text-align: right;">50.86</td></tr> <tr><td>CO-MED CARE FAC</td><td style="text-align: right;">1.00000</td><td style="text-align: right;">59.00</td></tr> <tr><td>CO-COM ON AGING</td><td style="text-align: right;">1.00000</td><td style="text-align: right;">59.00</td></tr> <tr><td>CO-PARKS & REC</td><td style="text-align: right;">0.35000</td><td style="text-align: right;">20.65</td></tr> <tr><td>10 TWP OPER</td><td style="text-align: right;">0.97390</td><td style="text-align: right;">57.46</td></tr> <tr><td>SHEPHERD SCH OP</td><td style="text-align: right;">18.00000</td><td style="text-align: right;">EXEMPT</td></tr> <tr><td>SHEP DEBT A08/17</td><td style="text-align: right;">7.00000</td><td style="text-align: right;">413.02</td></tr> <tr><td>GR/IS RESD OPER</td><td style="text-align: right;">0.26400</td><td style="text-align: right;">15.57</td></tr> <tr><td>GR/IS RESD SP ED</td><td style="text-align: right;">4.20000</td><td style="text-align: right;">247.81</td></tr> <tr><td>GR/IS RESD V ED</td><td style="text-align: right;">1.00000</td><td style="text-align: right;">59.00</td></tr> <tr><td>DUCEY #298</td><td></td><td style="text-align: right;">9.97</td></tr> <tr><td>D550R SAUNDERS</td><td></td><td style="text-align: right;">755.28</td></tr> <tr><td>10 TWP FIRE SP</td><td></td><td style="text-align: right;">25.00</td></tr> <tr><td colspan="2" style="text-align: right;">Total Mills/Tax</td><td style="text-align: right;">34.64990</td></tr> <tr><td colspan="2" style="text-align: right;">Administration Fee</td><td style="text-align: right;">9.91</td></tr> <tr><td colspan="2" style="text-align: right;">TOTAL AMOUNT DUE</td><td style="text-align: right;">1,782.53</td></tr> </tbody> </table>	TAX DESCRIPTION	MILLAGE	AMOUNT	CO-IRIDE TRANS	0.86200	50.86	CO-MED CARE FAC	1.00000	59.00	CO-COM ON AGING	1.00000	59.00	CO-PARKS & REC	0.35000	20.65	10 TWP OPER	0.97390	57.46	SHEPHERD SCH OP	18.00000	EXEMPT	SHEP DEBT A08/17	7.00000	413.02	GR/IS RESD OPER	0.26400	15.57	GR/IS RESD SP ED	4.20000	247.81	GR/IS RESD V ED	1.00000	59.00	DUCEY #298		9.97	D550R SAUNDERS		755.28	10 TWP FIRE SP		25.00	Total Mills/Tax		34.64990	Administration Fee		9.91	TOTAL AMOUNT DUE		1,782.53
TAX DESCRIPTION	MILLAGE	AMOUNT																																																		
CO-IRIDE TRANS	0.86200	50.86																																																		
CO-MED CARE FAC	1.00000	59.00																																																		
CO-COM ON AGING	1.00000	59.00																																																		
CO-PARKS & REC	0.35000	20.65																																																		
10 TWP OPER	0.97390	57.46																																																		
SHEPHERD SCH OP	18.00000	EXEMPT																																																		
SHEP DEBT A08/17	7.00000	413.02																																																		
GR/IS RESD OPER	0.26400	15.57																																																		
GR/IS RESD SP ED	4.20000	247.81																																																		
GR/IS RESD V ED	1.00000	59.00																																																		
DUCEY #298		9.97																																																		
D550R SAUNDERS		755.28																																																		
10 TWP FIRE SP		25.00																																																		
Total Mills/Tax		34.64990																																																		
Administration Fee		9.91																																																		
TOTAL AMOUNT DUE		1,782.53																																																		
TAX BASE VALUES	Description of Lands or Personal Property: lengthy descriptions subject to space limitations																																																			
<table style="width: 100%;"> <tr><td>Taxable Value:</td><td style="text-align: right;">59,003</td></tr> <tr><td>State Equalized Value:</td><td style="text-align: right;">112,500</td></tr> <tr><td>Assessed Value:</td><td style="text-align: right;">112,500</td></tr> <tr><td>Principal Residence Exemption:</td><td style="text-align: right;">59,003</td></tr> <tr><td>% Declared Exempt:</td><td style="text-align: right;">100.0000</td></tr> </table>	Taxable Value:	59,003	State Equalized Value:	112,500	Assessed Value:	112,500	Principal Residence Exemption:	59,003	% Declared Exempt:	100.0000	<p>A PARCEL OF LAND BEING PART OF THE S 1/4 OF THE NW 1/4 OF SECTION 14, T13N-R4W, LINCOLN TOWNSHIP, ISABELLA COUNTY, MICHIGAN, DESCRIBED AS FOLLOWS: COMMENCING AT THE W 1/4 COR OF SAID SECTION, THEN N 00D-21M-40S W, ON AND ALONG THE WEST LINE OF SAID SECTION, 511.50 FT, THEN N 89D-38M-20S E, PERPENDICULAR TO SAID WEST SECTION LINE 245 FT, THEN N 62D-09M-45S E, 185 FT, THEN N 89D-58M-20S E 367.62 FT TO THE POINT OF CURVATURE OF A CURVE TO THE RIGHT HAVING A RADIUS OF 60 FT, THEN SOUTHEASTERLY ALONG THE ARC OF SAID CURVE, 94.25 FT TO THE POINT OF TANGENCY, SAID ARC BEING SUBTENDED BY A CHORD BEARING S 15D 04M 10S E, 94.25 FT TO SAID POINT OF TANGENCY, THEN S 41D 31M 26S</p>																																									
Taxable Value:	59,003																																																			
State Equalized Value:	112,500																																																			
Assessed Value:	112,500																																																			
Principal Residence Exemption:	59,003																																																			
% Declared Exempt:	100.0000																																																			
OPERATING FISCAL YEARS	OPEN TO COLLECT TAXES AT LINCOLN TWP HALL OFFICE TUESDAY, DECEMBER 30, 2025 FROM 9 AM TO 5 PM. ALSO ON MONDAY, MARCH 2, 2026 FROM 9 AM TO 5 PM. TAKING COLLECTION BY MAIL IS PREFERRED. RECEIPT WILL BE RETURNED BY MAIL.																																																			
<table style="width: 100%;"> <tr><td>County:</td><td>10/01/2025</td><td>-</td><td>09/30/2026</td></tr> <tr><td>Twn/Cty/Village:</td><td>04/01/2025</td><td>-</td><td>03/31/2026</td></tr> <tr><td>School:</td><td>07/01/2025</td><td>-</td><td>06/30/2026</td></tr> <tr><td>State:</td><td>10/01/2025</td><td>-</td><td>09/30/2026</td></tr> </table> <p>Does NOT affect when the tax is due or its amount</p>	County:	10/01/2025	-	09/30/2026	Twn/Cty/Village:	04/01/2025	-	03/31/2026	School:	07/01/2025	-	06/30/2026	State:	10/01/2025	-	09/30/2026																																				
County:	10/01/2025	-	09/30/2026																																																	
Twn/Cty/Village:	04/01/2025	-	03/31/2026																																																	
School:	07/01/2025	-	06/30/2026																																																	
State:	10/01/2025	-	09/30/2026																																																	
<p>FOR QUESTIONS RELATING TO OWNER NAME, ADDRESS, DESCRIPTION AND/OR ASSESSMENT ISSUES, PLEASE CONTACT: THOMAS RAMON TWP SUPERVISOR/ASSESSOR PHONE: 989-944-3000 EMAIL: TOM.RAMON@HOTMAIL.COM</p>	<p>DUE AND PAYABLE 12/01/2025 THROUGH 03/02/2026 WITHOUT PENALTY. AS OF 03/03/2026 PAYABLE TO ISABELLA COUNTY TREASURER WITH A 4% ADMIN FEE AND 1% INTEREST PER MONTH UNTIL PAID. CONTACT ISABELLA COUNTY TREASURER FOR DELINQUENT PAYOFF AMOUNTS. POSTMARKS ARE NOT ACCEPTED BY THE TOWNSHIP OR COUNTY TREASURER.</p>																																																			

Additional information about PRE's, ESCROW ACCOUNTS, TAX DEFERMENT and more on reverse side

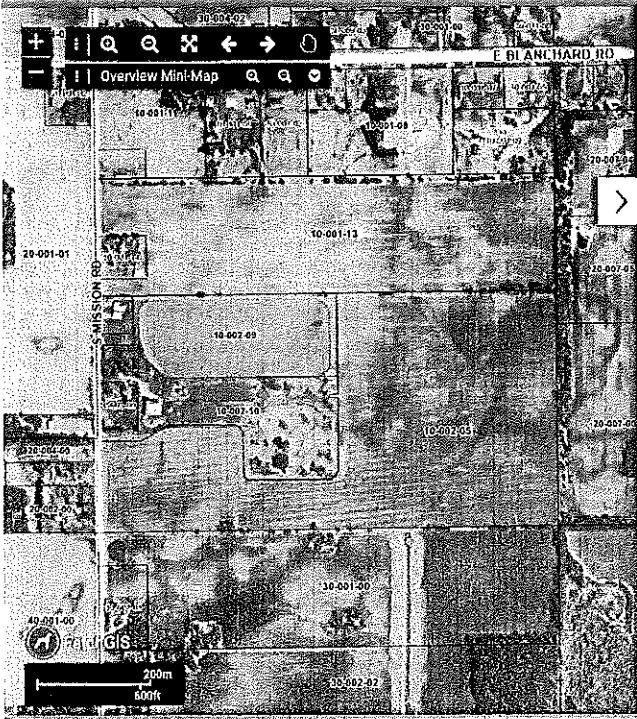

Property Details: 10-014-10-002-05

Report

Prev Year Info	MBOR Assessed	Final SEV	Final Taxable
2024	\$112,500	\$112,500	\$57,229
2023	\$103,100	\$103,100	\$54,504

Land Information

Acreage:	53.13
Zoning:	
Town/Range/Sec	13N 04W 014

Tax Description

A PARCEL OF LAND BEING PART OF THE S 1/2 OF THE NW 1/4 OF SECTION 14, T13N-R4W, LINCOLN TOWNSHIP, ISABELLA COUNTY, MICHIGAN, DESCRIBED AS FOLLOWS: COMMENCING AT THE W 1/4 COR OF SAID SECTION, THEN N 00D-21M-40S W, ON AND ALONG THE WEST LINE OF SAID SECTION, 511.50 FT; THEN N 89D-38M-20S E, PERPENDICULAR TO SAID WEST SECTION LINE 245 FT, THEN N 62D-09M-45S E, 185 FT, THEN N 89D-58M-20S E 367.62 FT TO THE POINT OF CURVATURE OF A CURVE TO THE RIGHT HAVING A RADIUS OF 60 FT, THEN SOUTHEASTERLY ALONG THE ARC OF SAID CURVE, 94.25 FT TO THE POINT OF TANGENCY, SAID ARC BEING SUBTENDED BY A CHORD BEARING S 45D-01M-40S E, 84.85 FT TO SAID POINT OF TANGENCY, THEN S 01D-31M-35S W, 218.66 FT TO THE POINT OF CURVATURE OF A CURVE TO THE LEFT HAVING A RADIUS OF 35 FT; THEN SOUTHEASTERLY, ALONG THE ARC OF SAID CURVE, 56.39 FT TO THE POINT OF TANGENCY, SAID ARC BEING SUBTENDED BY A CHORD BEARING S 44D-34M-26S E, 50.49 FT TO THE SAID POINT OF TANGENCY, THEN N 89D-15M-59S E PARALLEL WITH EAST AND WEST 1/4 LINE OF SAID SECTION, 451.65 FT TO THE POINT OF CURVATURE OF A CURVE TO THE LEFT HAVING A RADIUS OF 60 FT; THEN NORTHEASTERLY, ALONG THE ARC OF SAID CURVE, 94.62 FT TO THE POINT OF TANGENCY, SAID ARC BEING SUBTENDED BY A CHORD BEARING N 44D-05M-24S E, 85.11 FT TO SAID POINT OF TANGENCY, THEN N 01D-05M-11S W 396.21 FT; THEN S 88D-54M-49S W 48.82 FT, THEN N 01D-05M-11S W 20 FT; THEN N 88D-54M-49S E 48.82 FT; THEN N 01D-05M-11S W 570.48 FT TO A POINT OF THE NORTH 1/8 LINE OF SAID SECTION; THEN N 89D-13M-18S E ON AND ALONG SAID NORTH 1/8 LINE, 1293.19 FT TO A POINT ON THE NORTH AND SOUTH 1/4 LINE OF SAID SECTION; THEN S 00D-18M-51S E ON AND ALONG SAID NORTH AND SOUTH 1/4 LINE, 1322.10 FT TO THE INTERIOR 1/4 CORNER OF SAID SECTION, BEING THE INTERSECTION OF THE NORTH AND SOUTH 1/4 LINE WITH THE EAST AND WEST 1/4 LINE; THEN S 89D-15M-59S W ON AND ALONG THE EAST AND WEST 1/4 LINE OF SAID SECTION, 2655.28 FT, BACK TO THE POB CONTAINING 53.13 ACRES OF LAND AND BEING SUBJECT TO HIGHWAY USE OF THE WESTERLY 33 FT THEREOF LYING ALONG AND ADJACENT TO THE WEST LINE OF SAID SECTION. COMBINATION/SPLIT FOR 2018 COMBINED 10-002-03 & 10-002-04 SPLIT TO 10-002-05 & 10-002-06. AG EXEMPT TRANSFER FOR AFFID L1765 P796 REGISTERED 04-12-17 FOR SALE WD L1765 P794 DATED 04-12-17 WITH 2018 CAPPED TV = 47495 & AV = 78800

Please print or type responses. Attach additional sheets as needed. Refer to the Eligibility and Instructions document before filling out this form.

ALL APPLICATIONS MUST BE APPROVED BY LOCAL GOVERNING BODY ON OR BEFORE NOVEMBER 1 TO BE EFFECTIVE FOR THE CURRENT TAX YEAR.

OFFICIAL USE ONLY

Local Governing Body

FILED

Date received: _____

FEB 23 2026

Application #: _____

COUNTY CLERK
ISABELLA COUNTY
MT. PLEASANT MICH.

I. Personal Information

1. Name(s) of applicant

Klumpp Michael A

Last First Initial

(If more than two, see #18) Klumpp Jaime L

Last First Initial

2. Entity name:

Mike and Jaime Klumpp Holdings L.L.C.

3. Mailing address:

300 S University Mt. Pleasant MI 48858

Street City State Zip Code

4. Phone number: (989) 621-3577

5. Alternative telephone number (cell, work, etc.): (989) 621-3579

6. Email address: mklumpp@mak56.com

II. Property Location (can be taken from the deed/land contract)

7. County: Isabella

8. Township, city, or village: Union

9. Section #: 29 Town #: 14

Range #: 4 Parcel # (Tax ID): 14-029-30-005-00

III. Legal Information

10. Attach a clear copy of the recorded deed or land contract. Must include all pages and must include the legal description. (See #15, #16, and #17)

11. Date of purchase from your deed: 11/19/2025

NOTE: If land was transferred from yourself to your trust, a copy of the previous deed indicating whom you purchased it from is required.

12. Attach a clear copy of the most recent tax assessment or tax bill with complete tax description of property.

13. Is there a tax lien against the land described above? Yes No

If "Yes," please explain circumstances:

14. Does the applicant own the mineral rights? Yes No Unknown

If owned by the applicant, are the mineral rights leased? Yes No

Indicate who owns or is leasing rights if other than the applicant:

MAK Oil & Gas

Name the type(s) of mineral(s) involved: Oil, gas, and other minerals.

15. Is land cited in the application subject to a lease agreement (other than for mineral rights) permitting use for something other than agricultural purposes? Yes No

If "Yes," indicate to whom, for what purpose, and the number of acres involved:

16. Is land cited in the application subject to any other encumbrances (such as easements) that would prohibit agricultural use of the property, or impact the applicant's eligibility for the farmland tax credit? Yes No Unknown

If "Yes," indicate the type of encumbrance and grantee:

17. Is land being purchased under land contract? Yes No

If "Yes," a complete copy of the recorded land contract is required and must include the name and address of both the vendor (seller) and vendee (buyer).

If the property is under land contract, the vendor (seller) must agree to allow the land cited in the application to be enrolled in the program. Please have the land contract seller sign below (all sellers must sign).

Land Contract Vendor(s): I, the undersigned, understand and agree to permit the land cited in this application to be enrolled in the Farmland and Open Space Preservation Program.

Printed Name of Land Contract Vendor (Seller)

Signature of Land Contract Vendor (Seller)

Date

18. Please check the appropriate selection(s) below. A copy of the executed document supporting your choice must be provided (trust, agreement, articles of incorporation, etc.).

- 2 or more persons have a joint or common interest in the land
- Corporation Limited Liability Company Partnership
- Estate Trust Association

If applicable, list the following: Individual Names if more than 2 Persons, President, Vice President, Secretary, Treasurer, Trustee(s), Member(s), Partner(s), or Estate Representative(s):

Name: _____ Title: _____

Name: _____ Title: _____

Name: _____ Title: _____

Name: _____ Title: _____

(Additional names may be attached on a separate sheet)

LAND ELIGIBILITY

IV. Land Eligibility Qualifications: Check one and fill out the correct section(s).

This application is for

- 40 acres or more and 51% agriculture use → Complete only Section 19 (a-g).
- 5 acres or more but less than 40 acres and 51% agriculture use and income requirement → Complete only Sections 19 and 20.
- A specialty farm of 15 acres or more → Complete only Sections 19 and 21.

19. a. Type of agricultural enterprise (e.g. livestock, cash crops, fruit, etc.):

Cash crops

b. Total number of acres on this farm: 40

c. Total number of acres to be enrolled (if different than above): _____

d. Acreage in cultivation: 40

e. Acreage in cleared, fenced, improved pasture, or harvested grassland: 0

f. All other acres (swamp, woods, etc.): 0

g. Indicate any structures on the property (If more than one structure, indicate the number of structures):

Total: 0

NOTE: Rental houses and other non-agricultural structures are not considered a permitted use and will require a survey to exclude these uses from the application.

Description of structures (include items such as residence, barn, shed, silo, wind turbines, cell towers, etc.): _____

20. To qualify as agricultural land of 5 acres or more but less than 40 acres, the land must produce a gross annual income from agriculture of \$200.00 per year or more per acre of cleared and tillable land.

- » Supporting documentation is necessary to validate the income requirements.
- » Landowner signature on the application is required to certify the income information provided.
- » A signed statement by a licensed professional (such as an attorney or accountant) may also be provided.

21. To qualify as a specialty farm, the land must be 15 acres or more in size, and produce a gross annual income from an agricultural use of \$2,000 or more. If applying as a specialty farm, provide a signed affidavit attesting to the annual income earned during 2 of the prior 3 years immediately preceding the application. A signed affidavit by a licensed professional is preferred (such as an attorney or accountant). Include supporting documentation.

NOTE: A specialty farm designation by MDARD may require an on-site visit by an MDARD staff person.

22. Number of years requested to enroll in a Farmland Agreement (minimum 10 years, maximum 90 years): 10

LANDOWNER SIGNATURE REQUIRED ON PAGE 8

V. Signature(s)

23. The undersigned certifies the information contained in this application is accurate and true, and identifies the owner of record, legal description of property, and all encumbrances affecting the title of the land.
24. The undersigned certifies that there are no additional encumbrances that would impact the agreement or eligibility for the farmland tax credit including:
- a. Other conservation easements that would prevent agricultural use on the property.
 - b. Other easements granted to non-MDARD entities that could impact farmland tax credit eligibility.

Michael Klumpp

Printed Name of Applicant

Member

Title

[Signature]

Signature of Applicant (Corporate Name, If Applicable)

2-10-26

Date

Jaime Klumpp

Printed Name of Co-owner, If Applicable

Member

Title

[Signature]

Signature of Co-owner, If Applicable (Signature of Corporate Officer)

2-10-26

Date

ALL APPLICATIONS MUST BE APPROVED BY LOCAL GOVERNING BODY ON OR BEFORE NOVEMBER 1 IN ORDER TO BE EFFECTIVE FOR THE CURRENT TAX YEAR.

RESERVED FOR LOCAL GOVERNMENT USE: COMPLETED BY CLERK

I. Application Processing

Date application received: 2-23-2026 (Note: Local governing body has 45 days to take action)

Date action taken by local governing body jurisdiction: _____

County Township City Village

Included documentation: Resolution Meeting Minutes

This application is Approved Rejected

*Clerk must complete verification on the next page.

Date of approval or rejection by local governing body: _____

(If rejected, please attach statement from local governing body indicating reason(s) for rejection)

Property appraisal: \$ _____

Assessor certifies this is the current fair market value of the property.

Parcel # (Tax ID): _____

Clerk's name: Minde B. Lux

Clerk's phone: 989 317 4070

Clerk's email: mlux@isabelbcountry.org

Minde B. Lux

Minde B. Lux

Printed Name of Clerk

Signature of Clerk

Date

Assessor's name: _____

Assessor's phone: (____) _____ - _____ Assessor's email: _____

Printed Name of Assessor

Signature of Assessor

Date

LOCAL GOVERNING BODY VERIFICATION IS FOUND ON PAGE 10

II. Verification

Please verify the following:

- Upon filing an application, clerk issues receipt to the landowner indicating date received.
- Clerk notifies reviewing agencies by forwarding a copy of the application and attachments.
- If rejected, applicant is notified in writing within 10 days stating reason for rejection and the original application, attachments, etc. are returned to the applicant. Applicant then has 30 days to appeal to MDARD.
- If approved, applicant is notified within 10 days of the vote taken. Original application, board resolution or meeting minutes, and other supporting documentation (owner, size, use, and income documents if applicable), or emails to reviewing agencies for review/comment are sent to address at the bottom of the page.

PLEASE DO NOT SEND MULTIPLE COPIES OF APPLICATIONS AND/OR SEND ADDITIONAL ATTACHMENTS IN SEPARATE MAILINGS WITHOUT FIRST CONTACTING THE FARMLAND PRESERVATION OFFICE.

Please verify the following regarding Reviewing Agencies

(The application must be sent to all reviewing agencies below for comment. Copies of the emails or letters to each reviewing agency should be included with the application package provided to MDARD.)

COPY SENT TO:

- County or Regional Planning Commission
- Conservation District
- Township (if county has zoning authority)

Before forwarding to State Agency

FINAL APPLICATION MUST INCLUDE:

- Copy of local governing body meeting minutes and/or resolution of approval
- Copy of deed or land contract (most recent showing current ownership)
- Copy of most recent tax bill (tax description and property assessment must be included)
- Map of farm
- Assessing office statement (fair market value)
- Copy of letters from review agencies (if available)
- Any other applicable documents (such as proof of income)

The local governing body can send completed applications to:

Mailing Address:
MDARD FARMLAND AND OPEN SPACE
PRESERVATION PROGRAM
P.O. BOX 30449
LANSING, MI 48909

Email: MDARD-PA116@Michigan.gov
Phone: 517-284-5663
Fax: 517-335-3131

RECEIVED: 11/19/2025 02:04 PM
ISABELLA REGISTER OF DEED

Document # 202500055509 QUIT C DEED
Isabella County, Michigan
Karen Jackson, Register of Deeds
Recorded: 11/19/2025 03:10 PM
OR LIBER 1914 PAGE 4374

QUIT CLAIM DEED-Statutory Form-MCL 565.152

KNOW ALL PERSONS BY THESE PRESENTS: That Michael A. Klumpp, a married man,
whose address is: 1955 E. Walton Rd, Shepherd, MI 48883

Quit Claim(s) to Mike and Jaime Klumpp Holdings, L.L.C. , a Michigan limited liability company,
whose address is 300 S University St. Mt. Pleasant, MI 48858

the following described premises situated in the Township of Union, County of Isabella and
State of Michigan, to-wit:

The SE ¼ of the SW ¼ of section 29, T14N, R4W, Union Township, Isabella County, Michigan
Commonly known as: E. Deerfield Rd. Mt. Pleasant, MI, 48858

Tax I.D.Number: 14-029-30-005-00

for the full consideration of : \$1.00

Dated this 19 day of November 2025

Signed by:

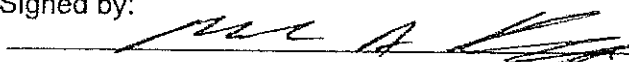
Michael A. Klumpp, a married man

STATE OF MICHIGAN
COUNTY OF ISABELLA

The foregoing instrument was acknowledged before me this 19 day of NOVEMBER, 2025
By Michael A. Klumpp, a married man

Bethany Myers
(Notary Public Signature)

Bethany Myers
(Notary Public Printed Name)

State of Michigan, County of Ottawa, Acting in the county of Isabella, MI
(county) (state)

My commission expires: June 1, 2029

Instrument drafted by: Kaitlyn Klumpp
300 S University Mt. Pleasant MI 48858
After recording return to:
Mike and Jaime Klumpp Holdings LLC
300 S. University Mt. Pleasant MI 48858

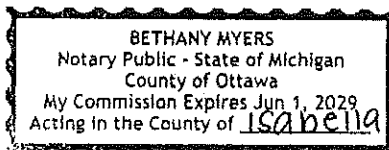

MESSAGE TO TAXPAYER
 POSTMARK DATE IS NOT HONORED FOR DUE DATE
 Winter Taxes are due by 11:59 on 02/17/2026
 After 2/17/2026, 3% penalty will be added.
 Look up Taxes Due and Pay online at:
 www.uniontownshipmi.com
 Questions? contact Township Treasurer

PAYMENT INFORMATION
 This tax is due by: 02/17/2026
 Pay by mail to: Charter Township of Union
 Treasurer
 2010 S. Lincoln Road
 Mt. Pleasant, MI 48858
 989-772-4600 Ext. 228
 See reverse side for additional information

SUMMER TAXES OWING

PROPERTY INFORMATION
 Property Assessed To:
 KLUMPP MICHAEL A
 7700 S WHITEVILLE RD
 SHEPHERD, MI 48883
 QUALIFIED AGRICULTURAL PROPERTY EXEMPTION
 Prop #: 14-029-30-005-00 School: MT PLEASANT
 Prop Addr: E DEERFIELD RD
 Legal Description:
 T14N R4W, SEC 29; SE 1/4 OF SW 1/4
 PURCHASED IN 2016, IMMEDIATELY FILED PA 260 AFFIDAVIT
 ATTESTING PROPERTY WILL BE USED FOR AGRICULTURAL
 PURPOSES. 7 YEAR RECAPTURE OF TAXES IF USE CHANGES.

Courtesy Notice: Prior year taxes were turned
 over as delinquent to the County Treasurer.
 Please call 989-772-0911 x 258 for current

TAX DETAIL		
Taxable Value:	23,565	AGRICULTURAL-VACAN
State Equalized Value:	124,800	Class: 102
PRE/MBT %:	100.0000	
DESCRIPTION	MILLAGE	AMOUNT
ICTC	0.86200	20.31
Medical Care Fac	1.00000	23.56
Comm on Aging	1.00000	23.56
Parks and Rec	0.35000	8.24
Township Oper	1.00000	23.56
Township Fire	2.25000	53.02
MPPS Oper	18.00000	EXEMPT
MPPS Debt 2016	0.94000	22.15
MPPS Debt 2022	1.48000	34.87
MPPS Debt 2024	1.32000	31.10
Grat/Isab RESP	0.26400	6.22
Grat/Isab SpEd	4.20000	98.97
Grat/Isab Voc Ed	1.00000	23.56
Chippewa Library	1.75000	41.23
Mid Mich College	1.21210	28.56
Total Tax	36.62810	438.91
Administration Fee		4.38
TOTAL AMOUNT DUE		443.29

OPERATING FISCAL YEARS
 The taxes on bill will be used for governmental
 operations for the following fiscal year(s):
 County: 10/01/25 - 09/30/26
 Township: 1/1/26 - 12/31/26
 School: 7/1/25 - 6/30/26
 State: 10/1/25 - 9/30/26
 Does NOT affect when the tax is due or its amount

POSTMARK DATE IS NOT HONORED FOR DUE DATE
 If not paid by 2/17/26, these 2025 taxes can be paid at the
 hall or on-line through 3/02/26 with additional penalty,
 but will be turned over to the county on 3/03/26 where
 more fees will be added.

Please keep the top portion.

Mortgage Co:

Mail Payment To:

Charter Township of Union
 Treasurer
 2010 S. Lincoln Road
 Mt. Pleasant, MI 48858
 989-772-4600 Ext. 228

TAXPAYER NOTE: Are your name & mailing address correct?
 Contact Union Township at 989-772-4600 for help, or you
 can find a fillable form on our website.

PLEASE RETURN BOTTOM PORTION OF BILL WITH YOUR PAYMENT

This tax is due by: 02/17/2026
 PAY ONLINE: www.uniontownshipmi.com

2025 Winter Tax for Prop #: 14-029-30-005-00

Property Addr: E DEERFIELD RD

Make Check Payable To: Charter Township of Union

TOTAL AMOUNT DUE: 443.29

Amount Remitted:

CHK

Cash

*****AUTO-MIXED AADC 453
 KLUMPP MICHAEL A
 7700 S WHITEVILLE RD
 SHEPHERD, MI 48883-9566





Property Details: 14-029-30-005-00 Report

General Information for 2025 Tax Year

Parcel Number:	14-029-30-005-00	Assessed Value:	\$124,800
Prop. Class Code:	102	Taxable Value:	\$23,565
Prop. Class Name:	AGRICULTURAL-VACANT	State Equalized Value:	\$124,800
School Dist Code:	37010	Exemption Percent:	100
School Dist Name:	MT PLEASANT CITY SCHOOL DIST		

Prev Year Info	MBOR Assessed	Final SEV	Final Taxable
2024	\$109,200	\$109,200	\$22,857
2023	\$101,400	\$101,400	\$21,769

Land Information

Acreage:	40
Zoning:	
Town/Range/Sec	14N 04W 029

Tax Description

T14N R4W, SEC 29; SE 1/4 OF SW 1/4, AG EXEMPT TRANSFER FOR AFFID L1649 P854 REGISTERED 10-15-13 FOR SALE QC L1646 P424 DATED 09-06-13 WITH 2014 CAPPED TV = 18071 & AV = 91700, AG EXEMPT TRANSFER FOR AFFID L1721 P257 REGISTERED 01-20-16 FOR SALE WD L1721 P249 DATED 01-19-16 WITH 2017 CAPPED TV = 18580 & AV = 79300

